

CITY COUNCIL
Mark Gran - Mayor
Doug Cox - Mayor Pro-Tem
Geoff Dale – Council Member
Betty Sampson - Council Member
James Tucker - Council Member

CITY CLERK
Debra Jackson

CITY TREASURER
Stacy Cox

January 20, 2015

RE: ***NOTICE INVITING PROPOSALS for
Hydrology/Drainage Report for
Imperial Equestrian & Events Center Project.***

The City purchased approximately 146 acres within the Sphere of Influence to develop a regional park with an events center and a sportsplex as the major amenities. The events center will contain covered and open arenas of sufficient size to accommodate major events such as equestrian competitions, concerts, and trade shows.

The proposed Events and Equestrian Center is just outside the City's boundaries at the west side of LaBrucherie Road between Larsen Road and Ralph Road (APN 630-010-049). The property is currently being annexed into the City of Imperial. At the present time, the City is working on the completion of an environmental review in compliance with the California Environmental Quality Act (CEQA). See attached site plan and Draft Annexation Map for details.

The City of Imperial is requesting proposals from qualified and experienced engineering firms for the above stated project and will receive such bids in the offices of the Planning & Development Department, Engineering Division, at 400 S. Imperial Avenue, Imperial, California 92251 or via email to JVillegas@cityofimperial.org.

Scope of Work:

1. Hydrology/Drainage Report:

The analysis shall examine how the Project would impact drainage on and off-site and identify the necessary infrastructure that would be required to accommodate the proposed Project.

If on-site basins are required, specify size and where would they be located.

If flows drain to surrounding IID canals, is there sufficient capacity?

Would new off-site improvements to increase capacity be needed?.

2. Cost Estimate:

The work includes the preparation of an Engineer's Opinion of Probable Construction Cost based on Consultant's judgment as a design professional familiar with the local construction industry.

3. Schedule:

The City anticipates the Consultant will provide the services as expeditiously as practicable after receipt of a notice to proceed. The target date for submission of the Hydrology/Drainage Report to the City is February 2, 2015.

The City of Imperial reserves the right to reject any or all Proposals, and/or waive any informality on any Proposal.

Please direct all correspondence and proposal to my attention.

Should you have any questions, please contact me at your earliest possible convenience at (760) 355-3840 or via email to JVillegas@cityofimperial.org.

Sincerely,

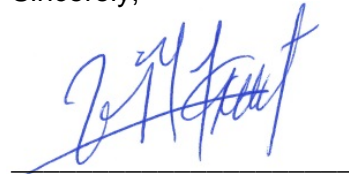

Jesus Villegas
Project Manager
Planning & Development Department
Engineering Division,

Existing Farmland
(Future Barioni Lakes Subdivision)

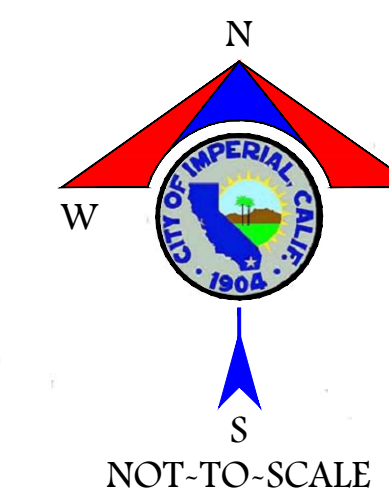
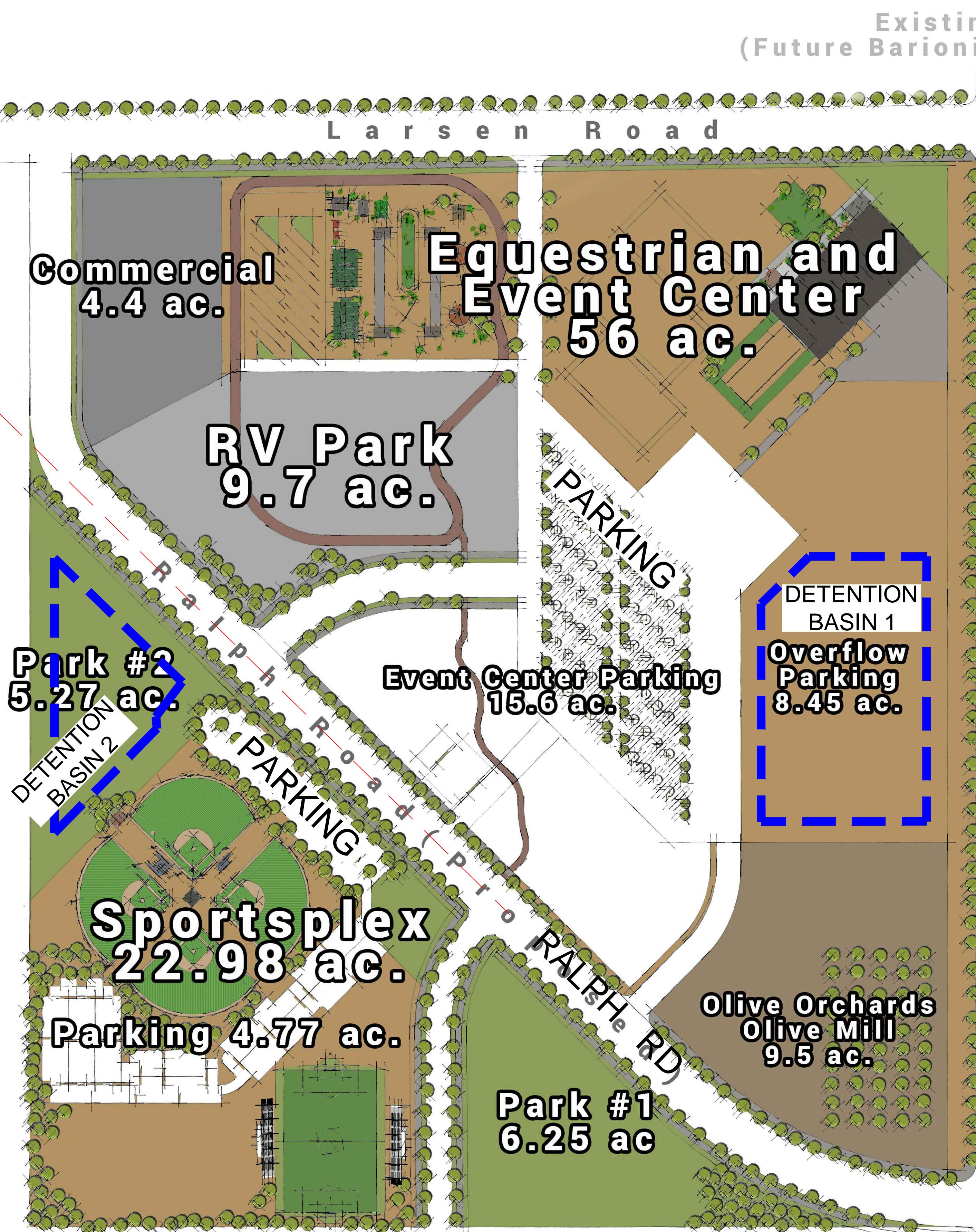

City of Imperial California

Regional Park and Equestrian Events Center

Existing Farmland
(Future Barioni Lakes Subdivision)



420 South Imperial Avenue
Imperial, CA 92251
Ph: (760) 355-3840 • Fax: (760) 355-4718

IMPERIAL EQUESTRIAN CENTER AND REGIONAL PARK

PLANNING & DEVELOPMENT DEPARTMENT

DETENTION BASINS

DATE: 18/18/2014

SHEET

1

OF 1 SHEETS

ANNEXATION NO. XX-XX TO THE CITY OF IMPERIAL

DATE: 12/29/11

FOUND IMP CO SURV CONC CYL W/ BRASS DISK, 1.50' BELOW BANK, PER IMPERIAL COUNTY SURVEYOR'S TIES, ACCEPTED AS SOUTHWEST CORNER OF TRACT 138.

TR 63

PM 1275

LARSEN ROAD

APPROXIMATE CENTERLINE LOCATION OF LARSEN ROAD (PAVED)

137

FOUND 1-1/2-INCH IRON PIPE (I.D.) TAGGED 27137, 0.5' DEEP, PER IMPERIAL COUNTY SURVEYOR'S TIES, ACCEPTED AS NORTHWEST CORNER OF TRACT 144.

NW COR TR 144

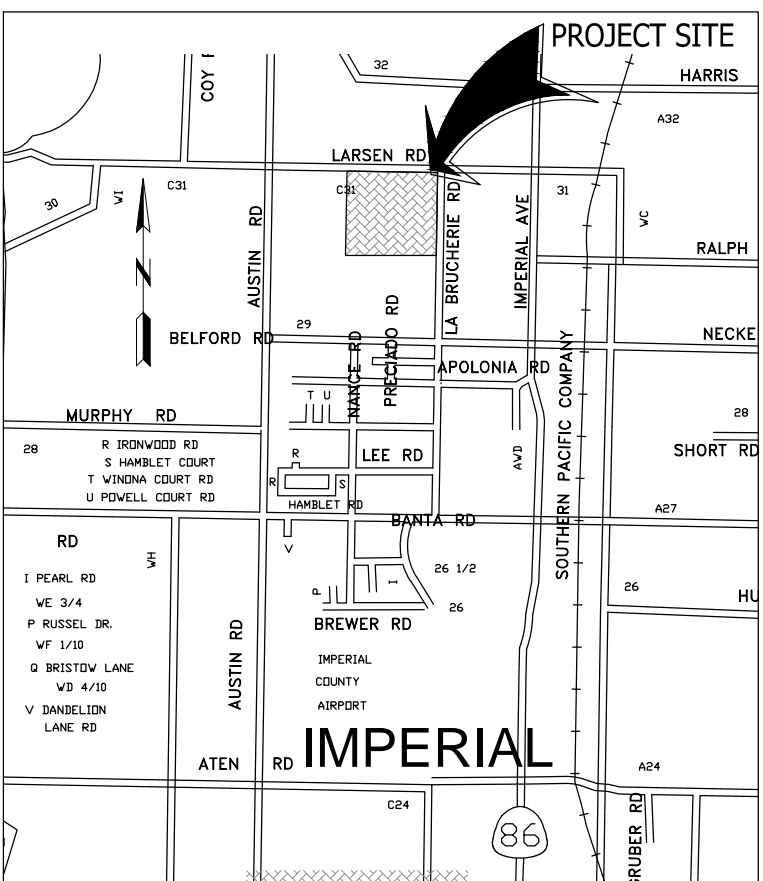
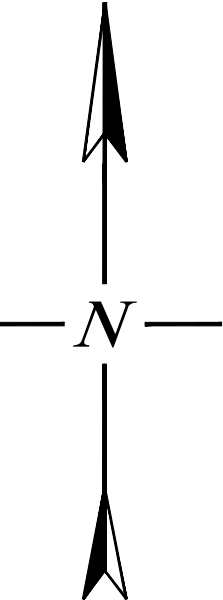

VICINITY MAP

PREPARED BY AND UNDER THE SUPERVISION OF

DAVID BELTRAN
EXP. DATE: 12/31/2012

P.L.S. 8482
12/31/2012

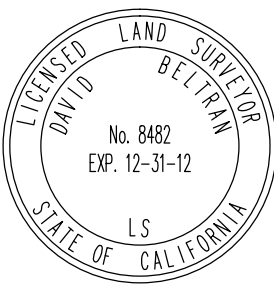

ANNEXATION XX-XX LEGAL DESCRIPTION:

THAT PORTION OF TRACT 136, TOWNSHIP 15 SOUTH, RANGE 13 EAST, SAN BERNARDINO MERIDIAN, ACCORDING TO THE UNITED STATES GOVERNMENT OFFICIAL PLAT OF RESURVEY APPROVED AND ON FILE IN THE UNITED STATES LAND OFFICE OF LOS ANGELES, CALIFORNIA, LYING BETWEEN DAHLIA AND NEWSIDE CANALS, CONTAINING 71.8 ACRES, MORE OR LESS;

EXCEPTING THEREFROM ANY PORTION LYING WITHIN PARCEL MAP 1125 IN BOOK 4, PAGE 58 OF PARCEL MAPS.

TOGETHER WITH,

THAT PORTION OF TRACT 137, TOWNSHIP 15 SOUTH, RANGE 13 EAST, SAN BERNARDINO MERIDIAN, ACCORDING TO THE UNITED STATES GOVERNMENT OFFICIAL PLAT OF RESURVEY APPROVED AND ON FILE IN THE UNITED STATES LAND OFFICE OF LOS ANGELES, CALIFORNIA, LYING BETWEEN DAHLIA AND NEWSIDE CANALS, CONTAINING 71.8 ACRES, MORE OR LESS;

EXCEPTING THEREFROM ANY PORTION LYING WITHIN PARCEL MAP 1275 IN BOOK 5, PAGE 38 OF PARCEL MAPS.

BASIS OF BEARING:

THE BEARING NORTH 89°33'57" EAST BETWEEN THE NORTHWEST CORNER OF TRACT 135 AND NORTHEAST CORNER OF TRACT 135 ON FILE IN BOOK 9, PAGE 20 OF RECORD OF SURVEYS IN THE OFFICE OF THE IMPERIAL COUNTY RECORDER.

LEGEND:

- TRACT LINE
- RIGHT OF WAY LINE
- PROPOSED ANNEXATION BOUNDARY
- MEASURED DATA
- CALCULATED DATA
- RECORD DATA PER RECORD OF SURVEY IN BOOK 9 PAGE 20
- RECORD DATA PER PARCEL MAP NO. M-1125 IN BOOK 4 PAGE 58
- RECORD DATA PER PARCEL MAP NO. M-2013 IN BOOK 8 PAGE 61
- RECORD DATA PER RECORD OF SURVEY IN BOOK 6 PAGE 29
- RECORD DATA PER PARCEL MAP NO. M-661 IN BOOK 2 PAGE 17
- RECORD DATA PER PARCEL MAP NO. M-1275 IN BOOK 5 PAGE 38

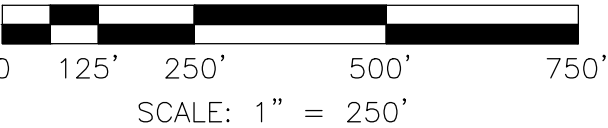

Dynamic CONSULTING ENGINEERS

TR 59

PM 2-17

PM 1125

TR

135

PM

2013

RALPH ROAD

FOUND 60D SPIKE W/ 2-INCH SHINER, FLUSH, PER IMPERIAL COUNTY SURVEYOR'S TIES, ACCEPTED AS NORTHEAST CORNER OF TRACT 135.

NE COR TR 135

TR 165

FOUND P.K. NAIL W/ TIES, FLUSH, PER IMPERIAL COUNTY SURVEYOR'S TIES, ACCEPTED AS NORTHEAST CORNER OF TRACT 134.

NE COR TR 134

FOUND 2-INCH IRON PIPE (O.D.) TAGGED 27137, 0.5' DEEP, PER IMPERIAL COUNTY SURVEYOR'S TIES, ACCEPTED AS NORTHEAST CORNER OF TRACT 136.

NE COR TR 136

APPROXIMATE CENTERLINE LOCATION OF LA BRUCHERIE ROAD (PAVED)

LA BRUCHERIE ROAD

136

9-20

ROS

N 89°34'08" E 5010.26' (M)
(N 89°34'19" E 5009.78' (1))

APPROXIMATE CENTERLINE LOCATION OF NEWSIDE DRAIN NO.1 (DIRT)

ANNEXATION
±145.55 ACRES

TR 62

FOUND 2-INCH (I.D.) 2-1/2" (O.D.) IRON PIPE, 0.50' DEEP, TAGGED R.C.E. 19834 PER IMPERIAL COUNTY SURVEYOR'S TIES, ACCEPTED AS NORTHWEST CORNER OF TRACT 136.

NW COR TR 136

N 00°01'48" E 1336.80' (M)
(S 00°02'44" W 1337.12' (1))
(N 00°00'55" E 1336.74' (5))

FOUND IMP CO SURV CONC CYL W/ BRASS DISK, 1.00' DEEP, PER IMPERIAL COUNTY SURVEYOR'S TIES, ACCEPTED AS NORTHWEST CORNER OF TRACT 135.

NW COR TR 135

N 89°36'47" W 2652.22' (M)

S 89°33'57" W 2366.43' (C)

N 89°33'57" E 5010.90' (M)
(N 89°33'57" E 5010.85' (1))
(N 89°33'34" E 5011.31' (2))

S 89°33'57" W 2620.59' (C)

HIGHWAY 86

N 00°00'10" W 1336.54' (M)
(NORTH 1336.57' (1))
(NORTH 1336.55' (4))

TR 148

N 00°00'51" E 2643.96' (M)
(N 00°00'11" E 2643.67' (2))
(NORTH 2643.54' (3))

ROS

TR 144

HIGHWAY 86

N 00°00'09" W 1318.24' (M)
(N 00°00'04" W 1318.12' (4))

FOUND 1-1/2-INCH IRON PIPE (I.D.) TAGGED 27137, 0.5' DEEP, PER IMPERIAL COUNTY SURVEYOR'S TIES, ACCEPTED AS NORTHWEST CORNER OF TRACT 144.

NW COR TR 144

APPROXIMATE CENTERLINE LOCATION OF DAHLIA CANAL (CONC)

S 00°00'16" W 1315.48' (C)

LA BRUCHERIE ROAD

APPROXIMATE CENTERLINE LOCATION OF LARSEN ROAD (PAVED)

LARSEN ROAD

PM 1275

TR 63

FOUND IMP CO SURV CONC CYL W/ BRASS DISK, 1.50' BELOW BANK, PER IMPERIAL COUNTY SURVEYOR'S TIES, ACCEPTED AS SOUTHWEST CORNER OF TRACT 138.

SW COR TR 138

N 00°00'21" E 1312.47' (M)
(NORTH 1312.29' (6))

N 00°00'21" E 2629.16' (M)
(NORTH 2628.80' (6))

APPROXIMATE CENTERLINE LOCATION OF NEWSIDE CANAL (CONC)

N 00°05'24" E 1316.66' (C)
(NORTH 1316.51' (6))