

DATE SUBMITTED 12/30/15  
 SUBMITTED BY PLANNING  
DIRECTOR  
 DATE ACTION REQUIRED 01/06/16

COUNCIL ACTION (X)  
 PUBLIC HEARING REQUIRED ( )  
 RESOLUTION ( )  
 ORDINANCE 1<sup>ST</sup> READING ( )  
 ORDINANCE 2<sup>ND</sup> READING ( )  
 CITY CLERK'S INITIALS ( )

## IMPERIAL SUCCESSOR AGENCY AGENDA ITEM

SUBJECT: DISCUSSION/ACTION: DOWNTOWN IMPERIAL PHASE 2 IMPROVEMENTS

1. AWARD SIDEWALK CONSTRUCTION CONTRACT TO GRANITE CONSTRUCTION IN THE AMOUNT OF \$311,000.00
2. AUTHORIZE CITY MANAGER TO APPROVE CHANGE ORDERS TO INCLUDE ADDITIONAL SIDEWALKS

DEPARTMENT INVOLVED: PLANNING, AND PUBLIC SERVICES

**BACKGROUND/SUMMARY:**

Bids were received and opened on December 28, 2015 for the Downtown Phase 2 Beautification project. Although two companies submitted a bid, one was rejected as a non-responsive bid (the packet was missing several required documents). The only responsive bid was for \$311,000.00. Together with the expenditures approved at the last Board meeting, the total cost for Phase 2 is \$676,333.00 which constitutes approximately 75% of the budget amount. At this cost, it may be possible to complete additional city blocks.

FISCAL IMPACT: \$311,000.00 from Successor Agency Funds F.O. INITIALS: \_\_\_\_\_

**STAFF RECOMMENDATION:**

Staff recommends award of construction contract to Granite Construction in the amount of \$311,000.

**MANAGER'S RECOMMENDATION:**

MANAGER'S INITIALS

**MOTION:**

SECONDED: AYES: NAYES: ABSENT:	APPROVED ( ) DISAPPROVED ( ) REJECTED ( ) DEFERRED ( ) REFERRED TO:
---	---



# CITY OF IMPERIAL DOWNTOWN BEAUTIFICATION PROJECT

## IMPERIAL AVE. FROM 6TH TO 7TH AND 9TH TO 10TH STREETS

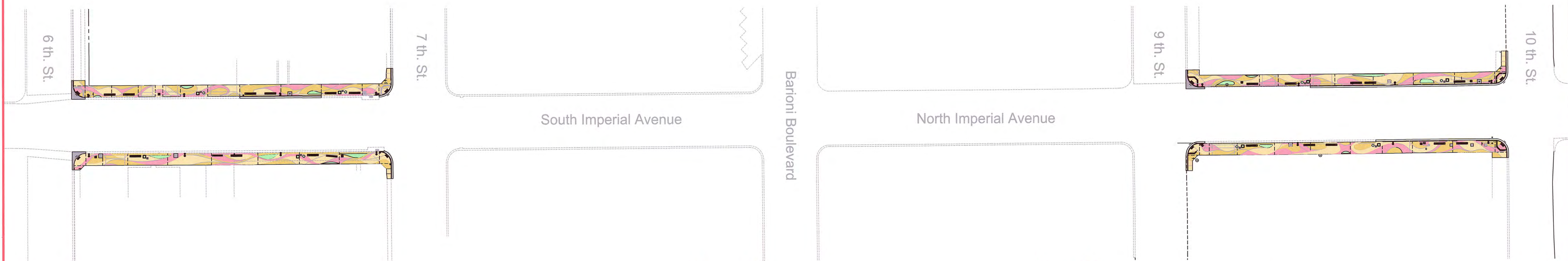

### LEGEND

SYMBOL	DESCRIPTION	SYMBOL	DESCRIPTION	SYMBOL	DESCRIPTION
	NEW STANDARD PCC CONCRETE SURFACE. SEE KEYNOTE NO. 5.		ALIGNMENT LINE		NEW 48" X 48" TREE WELL AND GRATE. SEE KEYNOTE NO. 9.
	NEW SANGRIA COLOR EXPOSED PEA GRAVEL AGGREGATE PCC CONCRETE SURFACE. SEE KEYNOTE NO. 4.		PROPERTY / RIGHT OF WAY LINE		NEW 37" X 25" ROUND PLANTER. SEE KEYNOTE NO. 12.
	NEW MESA BUFF COLOR EXPOSED PEA GRAVEL AGGREGATE PCC CONCRETE SURFACE. SEE KEYNOTE NO. 4.		NEW OFF-SITE IMPROVEMENTS		NEW 36" X 30" SQUARE PLANTER. SEE KEYNOTE NO. 11.
	NEW ADOBE COLOR EXPOSED PEA GRAVEL AGGREGATE PCC CONCRETE SURFACE. SEE KEYNOTE NO. 4.		EXISTING OFF-SITE IMPROVEMENTS		NEW 24" X 22" SQUARE PLANTER. SEE KEYNOTE NO. 10.
	NEW OPEN LANDSCAPE AREA.		NEW 3" EXPANSION JOINT		27 GAL. TRASH RECEPTACLE SHELL. SEE KEYNOTE NO. 13.
	NEW ASPHALT-RUBBER AGGREGATE MEMBRANE PAVEMENT TO BE INSTALLED.		NEW STOP SIGN		NEW WOOD FRAME STUCCO BENCH TYPE 1.
	NEW PCC CURB AND GUTTER. SEE KEYNOTE NO. 1.		NEW STREET LIGHT. SEE KEYNOTES NO. 7 AND 8.		NEW WOOD FRAME STUCCO BENCH TYPE 2.
	NEW 6" X 18" PCC FREE STANDING CURB. SEE KEYNOTE NO. 2.		NEW 5E ELECTRICAL BOX		
			EXISTING POLE		
			EXISTING STREET LIGHT		
			EXISTING WATER METER		
			EXISTING WATER VALVE		
			EXISTING FIRE HYDRANT		
			EXISTING ELECTRICAL STUB-OUT/PREP.		

### CONSTRUCTION KEYNOTES

- INSTALL NEW PCC CURB AND GUTTER AS PER CITY OF IMPERIAL STD. DETAIL NO. 21.
- INSTALL NEW 6" X 18" PCC FREE STANDING CURB. REFER TO TECHNICAL SPECIFICATIONS AS PER CITY OF IMPERIAL STD. DETAIL NO. 21. COORDINATE WITH CITY ENGINEERING DEPT. STAFF.
- INSTALL NEW PCC SIDEWALK AS PER CITY OF IMPERIAL STD. DETAIL NO. 25. REFER TO COLOR CODE AND FINISH AS PER THIS SET OF PLANS.
- INSTALL NEW 12" WIDE PCC SIDEWALK. REFER TO TECHNICAL SPECIFICATIONS AS PER CITY OF IMPERIAL STD. DETAIL NO. 21 UNLESS OTHERWISE NOTED. COORDINATE WITH CITY ENGINEERING DEPT. STAFF. REFER TO COLOR CODE AND FINISH AS PER THIS SET OF PLANS.
- INSTALL NEW 6" THICK 4,500 PSI PCC CONCRETE SPANDREL. MATCH EXISTING ASPHALT/CONCRETE SURFACE UNLESS OTHERWISE NOTED. CONCRETE MIX SHALL CONTAIN 1-3 LBS. OF POLYPROPYLENE FIBER PER CUBIC YARD. COORDINATE WITH CITY ENGINEERING DEPT. STAFF.
- INSTALL NEW HANDICAP RAMP. REFER TO TECHNICAL SPECIFICATIONS AS PER CITY OF IMPERIAL STD. DETAIL NO. 23 UNLESS OTHERWISE NOTED. COORDINATE WITH CITY ENGINEERING DEPT. STAFF. REFER TO COLOR CODE AND FINISH AS PER THIS SET OF PLANS.
- NEW 22" CLASS B ROSEMOUNT II STREET LIGHT BY SKY CAST INC. IMPERIAL, CA POLE TYPE, CALITE DWG# SC 220 BR2 NSE DTG P.
- NEW 27" CLASS B ROSEMOUNT II STREET LIGHT BY SKY CAST INC. IMPERIAL, CA POLE TYPE, CALITE DWG# SC 270 BR2 NSE DTG P.
- NEW 48" SQUARE "DTN" TREE GRATE BY OLYMPIC FOUNDRY INC. PART NO. 80-99, RATING N-A, TWO PIECE SET, 3/4" THICK GRATE.
- NEW 24" X 22" SQUARE PLANTER, IMPERIAL BY SAN DIEGO PRECAST CONCRETE INC. PART NO. P2422SQ-IMP. 540 LBS. 6,000 PSI.
- NEW 36" X 30" SQUARE PLANTER, IMPERIAL BY SAN DIEGO PRECAST CONCRETE INC. PART NO. P3630SQ-IMP. 1,235 LBS. 6,000 PSI.
- NEW 37" X 25" ROUND MEDITERRANEAN PLANTER, BY SAN DIEGO PRECAST CONCRETE INC. PART NO. P3725MDT. 790 LBS. 6,000 PSI.
- NEW 27 GAL. SQUARE TRASH RECEPTACLE SHELL, BY SAN DIEGO PRECAST CONCRETE INC. PART NO. HD06-TR27SQMOD. 1,020 LBS. 6,000 PSI. TRASH RECEPTACLE TO HAVE RECESSED PANELS ON 4 SIDES.

### DEMOLITION KEYNOTES

- SAWCUT, REMOVE AND DISPOSE EXISTING PCC APRRON. SAWCUT, REMOVE AND REPLACE ADJACENT EXISTING AG PAVEMENT AS NECESSARY. COORDINATE WITH CITY ENGINEERING DEPT. STAFF.
- REMOVE AND DISPOSE EXISTING PCC SIDEWALK, DRIVEWAY APPROACHES AND HANDICAP RAMPS. PROTECT IN PLACE ADJACENT IMPROVEMENTS AND/OR STRUCTURES. SAWCUT AS NECESSARY.

### SPECIAL NOTES

- NOTES:
- EXCEPTING BY THE STREET LIGHT POLES INSTALLATION; ALL OTHER ELECTRICAL WORK TO BE PERFORMED BY THE CITY OF IMPERIAL PUBLIC SERVICES DEPARTMENT. ALL SUPPLIES AND MATERIALS BY THE CITY OF IMPERIAL. ALL RELATED EQUIPMENT NEEDED FOR STREET LIGHT POLES INSTALLATION TO BE CONTRACTOR'S RESPONSIBILITY. CONTRACTOR TO COORDINATE WITH CITY OF IMPERIAL STAFF.
  - TREE GRATES AND FRAMES TO BE SUPPLIED BY THE CITY OF IMPERIAL. CONTRACTOR TO BE RESPONSIBLE FOR THE INSTALLATION AND ALL OTHER MATERIAL AND EQUIPMENT.
  - ALL PLANTERS, TRASH RECEPTACLES AND BENCHES TO BE SUPPLIED AND INSTALLED BY THE CITY OF IMPERIAL STAFF.
  - ALL IRRIGATION WORK BY THE CITY OF IMPERIAL. PUBLIC SERVICES DEPARTMENT. CONTRACTOR TO COORDINATE WITH CITY OF IMPERIAL STAFF.

### PROJECT ADDRESS:

NORTH IMPERIAL AVE. FROM 6TH STREET TO 7TH STREET AND  
SOUTH IMPERIAL AVE. FROM 9TH STREET TO 10TH STREET  
IMPERIAL, CA. 92251

### OWNER:

CITY OF IMPERIAL  
420 S. IMPERIAL AVE.  
IMPERIAL, CA. 92251

### ENGINEER:

VEYER ENGINEERING  
653 W. MAIN ST. SUITE 103  
EL CENTRO, CA. 92243  
PHONE (760) 352-8100

SHT.	NO.	CONTENT:
T1	1	TITLE SHEET
IP1	1	IMPROVEMENT PLANS
IP2	1	IMPROVEMENT PLANS

### DECLARATION OF RESPONSIBLE CHARGE

I HEREBY DECLARE THAT I AM THE ENGINEER OF THE WORK OF THIS PROJECT, THAT I HAVE EXERCISED RESPONSIBLE CHARGE OVER THE DESIGN OF THE PROJECT AS DEFINED IN SECTION 6703 OF THE BUSINESS AND PROFESSIONS CODE AND THAT THE DESIGN IS CONSISTENT WITH CURRENT STANDARDS.

I UNDERSTAND THAT CHECK OF THE PROJECT DRAWINGS AND SPECIFICATIONS BY THE CITY OF IMPERIAL IS CONFINED TO REVIEW ONLY AND DOES NOT RELIEVE ME, AS ENGINEER OF WORK, OF MY RESPONSIBILITY FOR PROJECT DESIGN.

ROBERTO MARTINEZ  
VEYER ENGINEERING  
653 W. MAIN ST. SUITE 103  
EL CENTRO, CA. 92243  
PHONE (760) 352-8100

BY:  
ROBERTO C. MARTINEZ P.E.  
R.C.E. NO. 74,475  
EXPIRATION DATE: 12/31/15

DATE:

### VICINITY MAP

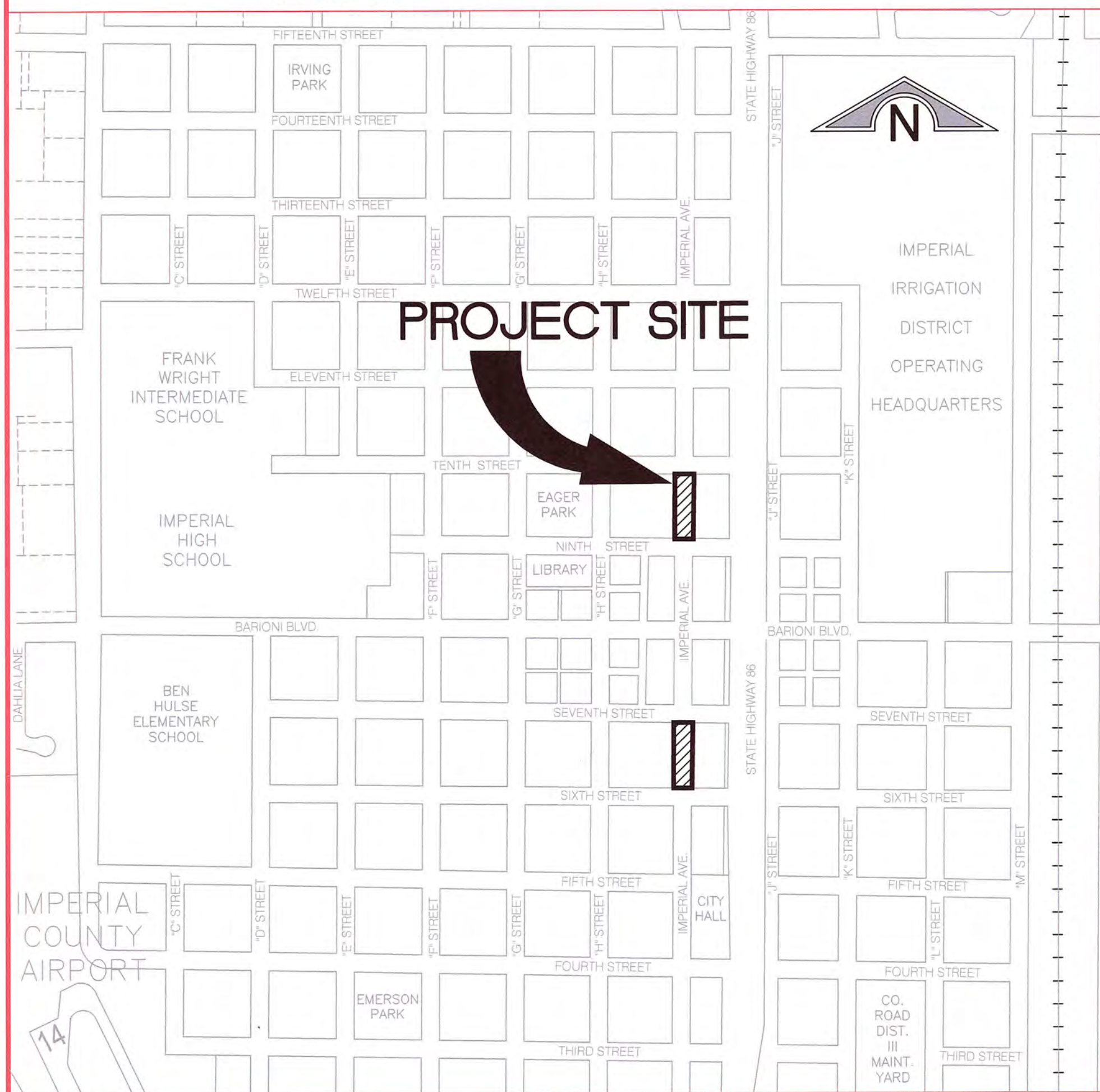

### REVISIONS

NO.	DESCRIPTION:	DATE:	BY:
Δ			
Δ			
Δ			

BY:  
ROBERTO C. MARTINEZ  
653 W. MAIN ST. SUITE 103  
EL CENTRO, CA 92243  
DATE: 05/14/15  
R.C.E. NO. C-74475



# T1

CITY OF IMPERIAL DOWNTOWN BEAUTIFICATION PROJECT  
IMPERIAL AVE. FROM 6TH TO 7TH AND 9TH TO 10TH STREETS

### SITE PLAN

IN THE CITY OF IMPERIAL, CALIFORNIA

SHEET: **1**  
OF: **3**  
DWN. BY: A.A.  
REV. BY: J.V.  
APPD. BY: J.G.

DATE: 11/11/15





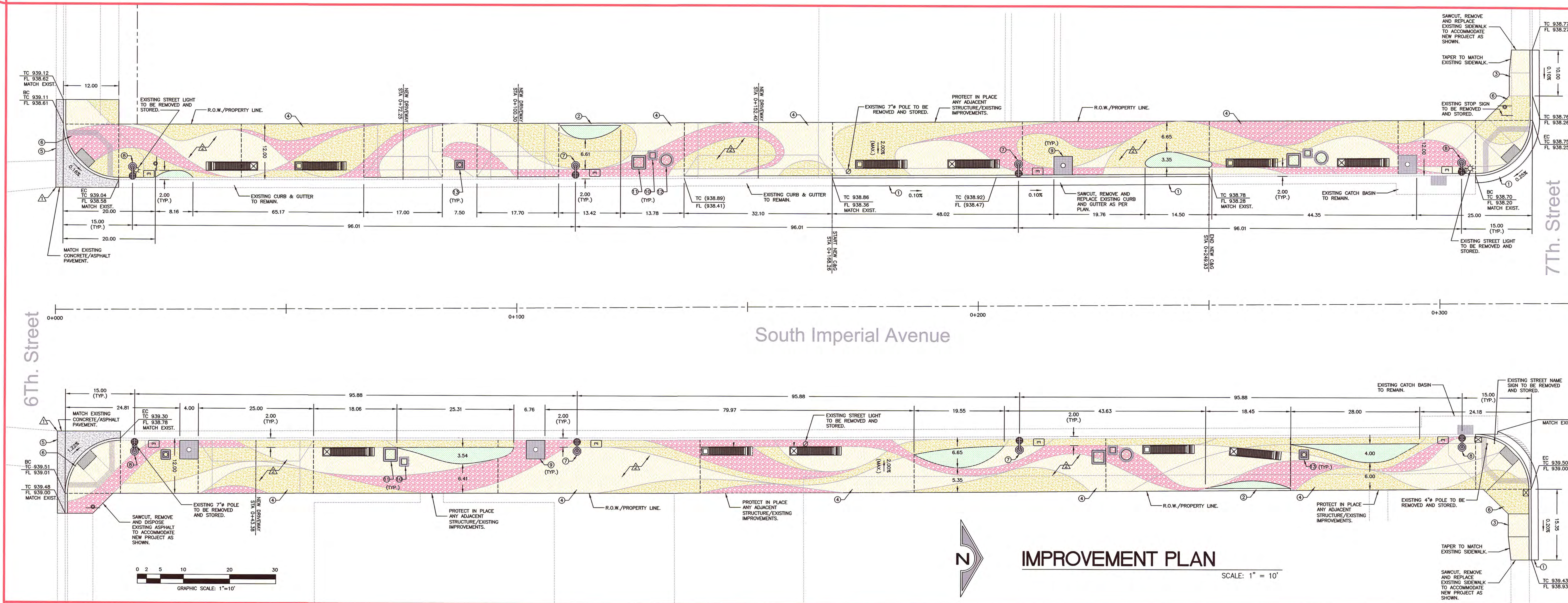

LEGEND					
SYMBOL	DESCRIPTION	SYMBOL	DESCRIPTION	SYMBOL	DESCRIPTION
	NEW STANDARD PCC CONCRETE SURFACE. SEE KEYNOTE NO. 5.		ALIGNMENT LINE		NEW 48" X 48" TREE WELL AND GRATE. SEE KEYNOTE NO. 9.
	NEW SANGRIA COLOR EXPOSED PEA GRAVEL AGGREGATE PCC CONCRETE SURFACE. SEE KEYNOTE NO. 4.		PROPERTY / RIGHT OF WAY LINE		NEW 37" X 25" ROUND PLANTER. SEE KEYNOTE NO. 12.
	NEW MESA BUFF COLOR EXPOSED PEA GRAVEL AGGREGATE PCC CONCRETE SURFACE. SEE KEYNOTE NO. 4.		NEW OFF-SITE IMPROVEMENTS		NEW 36" X 30" SQUARE PLANTER. SEE KEYNOTE NO. 11.
	NEW ADOBE COLOR EXPOSED PEA GRAVEL AGGREGATE PCC CONCRETE SURFACE. SEE KEYNOTE NO. 4.		NEW 1" EXPANSION JOINT		NEW 24" X 22" SQUARE PLANTER. SEE KEYNOTE NO. 10.
	NEW OPEN LANDSCAPE AREA.		NEW STOP SIGN		27 GAL. TRASH RECEPTACLE SHELL. SEE KEYNOTE NO. 13.
	NEW ASPHALT-RUBBER AGGREGATE MEMBRANE PAVEMENT TO BE INSTALLED.		NEW STREET LIGHT. SEE KEYNOTES NO. 7 AND 8.		NEW WOOD FRAME STUCCO BENCH TYPE 1.
	NEW PCC CURB AND GUTTER. SEE KEYNOTE NO. 1.		NEW SE ELECTRICAL BOX		NEW WOOD FRAME STUCCO BENCH TYPE 2.
	NEW 6" X 18" PCC FREE STANDING CURB. SEE KEYNOTE NO. 2.		EXISTING POLE		
			EXISTING STREET LIGHT		
			EXISTING WATER METER		
			EXISTING WATER VALVE		
			EXISTING FIRE HYDRANT		
			EXISTING ELECTRICAL STUB-OUT/PREP.		

CONSTRUCTION KEYNOTES		DEMOLITION KEYNOTES
1. INSTALL NEW PCC CURB AND GUTTER AS PER CITY OF IMPERIAL STD. DETAIL NO. 21.	2. NEW 24" X 22" SQUARE PLANTER, IMPERIAL BY SAN DIEGO PRECAST CONCRETE INC. PART NO. P2422SQ-IMP. 540 LBS. 6,000 PSI.	1. SAWCUT, REMOVE AND DISPOSE EXISTING PCC APPROX. SAWCUT, REMOVE AND REPLACE ADJACENT EXISTING AG. PAVEMENT AS NECESSARY. COORDINATE WITH CITY ENGINEERING DEPT. STAFF.
2. INSTALL NEW 6" X 18" PCC FREE STANDING CURB. REFER TO TECHNICAL SPECIFICATIONS AS PER CITY OF IMPERIAL STD. DETAIL NO. 21. COORDINATE WITH CITY ENGINEERING DEPT. STAFF.	3. NEW 36" X 30" SQUARE PLANTER, IMPERIAL BY SAN DIEGO PRECAST CONCRETE INC. PART NO. P3630SQ-IMP. 1,235 LBS. 6,000 PSI.	2. REMOVE AND DISPOSE EXISTING PCC SIDEWALK, DRIVEWAY APPROACHES AND HANDICAP RAMPS. PROTECT IN PLACE ADJACENT IMPROVEMENTS AND/OR STRUCTURES. SAWCUT AS NECESSARY.
3. INSTALL NEW PCC SIDEWALK AS PER CITY OF IMPERIAL STD. DETAIL NO. 25. REFER TO COLOR CODE AND FINISH AS PER THIS SET OF PLANS.	4. NEW 37" X 25" ROUND MEDITERRANEAN PLANTER, BY SAN DIEGO PRECAST CONCRETE INC. PART NO. P3725MDT. 790 LBS. 6,000 PSI.	
4. INSTALL NEW 12" WIDE PCC SIDEWALK. REFER TO TECHNICAL SPECIFICATIONS AS PER CITY OF IMPERIAL STD. DETAIL NO. 21 UNLESS OTHERWISE NOTED. COORDINATE WITH CITY ENGINEERING DEPT. STAFF. REFER TO COLOR CODE AND FINISH AS PER THIS SET OF PLANS.	5. NEW 27 GAL. SQUARE TRASH RECEPTACLE SHELL, BY SAN DIEGO PRECAST CONCRETE INC. PART NO. P3725MDT. 790 LBS. 6,000 PSI. TRASH RECEPTACLE TO HAVE RECESSED PANELS ON 4 SIDES.	
5. INSTALL NEW 6" THICK 4,500 PSI PCC CONCRETE SPANDREL MATCH EXISTING ASPHALT/CONCRETE SURFACE UNLESS OTHERWISE NOTED. CONCRETE MIX SHALL CONTAIN 1-3 LBS. OF POLYPROPYLENE FIBER PER CUBIC YARD. COORDINATE WITH CITY ENGINEERING DEPT. STAFF.		
6. INSTALL NEW HANDICAP RAMP. REFER TO TECHNICAL SPECIFICATIONS AS PER CITY OF IMPERIAL STD. DETAIL NO. 23 UNLESS OTHERWISE NOTED. COORDINATE WITH CITY ENGINEERING DEPT. STAFF. REFER TO COLOR CODE AND FINISH AS PER THIS SET OF PLANS.		
7. NEW 22' CLASS B ROSEMOUNT II STREET LIGHT BY SKY CAST INC. IMPERIAL, CA POLE TYPE, CALITE DWG# SC 220 BR2 NSE DTG P.		
8. NEW 27' CLASS B ROSEMOUNT II STREET LIGHT BY SKY CAST INC. IMPERIAL, CA POLE TYPE, CALITE DWG# SC 270 BR2 NSE DTG P.		
9. NEW 48" SQUARE "DTN" TREE GRATE BY OLYMPIC FOUNDRY INC. PART NO. 80-99, RATING N-A, TWO PIECE SET, 3" THICK GRATE.		

SPECIAL NOTES	
NOTES: 1.- EXCEPTING BY THE STREET LIGHT POLES INSTALLATION; ALL OTHER ELECTRICAL WORK TO BE PERFORMED BY THE CITY OF IMPERIAL PUBLIC SERVICES DEPARTMENT. ALL SUPPLIES AND MATERIALS BY THE CITY OF IMPERIAL. ALL RELATED EQUIPMENT NEEDED FOR STREET LIGHT POLES INSTALLATION TO BE CONTRACTOR'S RESPONSIBILITY. CONTRACTOR TO COORDINATE WITH CITY OF IMPERIAL STAFF. 2.- TREE GRATES AND FRAMES TO BE SUPPLIED BY THE CITY OF IMPERIAL. CONTRACTOR TO BE RESPONSIBLE FOR THE INSTALLATION AND ALL OTHER MATERIAL AND EQUIPMENT. 3.- ALL PLANTERS, TRASH RECEPTACLES AND BENCHES TO BE SUPPLIED AND INSTALLED BY THE CITY OF IMPERIAL STAFF. 4.- ALL IRRIGATION WORK BY THE CITY OF IMPERIAL PUBLIC SERVICES DEPARTMENT. CONTRACTOR TO COORDINATE WITH CITY OF IMPERIAL STAFF.	



REVISIONS			
NO.	DESCRIPTION:	DATE:	BY:
1			
2			
3			

BY: ROBERTO C. MARTINEZ 653 W. MAIN ST. SUITE 103 EL CENTRO, CA 92243 DATE: 05/14/15 R.C.E. NO. C-74475	SEAL: 
--	-----------

CITY OF IMPERIAL DOWNTOWN BEAUTIFICATION PROJECT  
IMPERIAL AVE. FROM 6TH TO 7TH AND 9TH TO 10TH STREETS  
IMPROVEMENT PLANS  
IN THE CITY OF IMPERIAL, CALIFORNIA

SHEET: **2**  
OF: **3**  
DWN. BY: A.A.  
REV. BY: J.V.  
APPD. BY: J.G.

DATE: 11/11/15



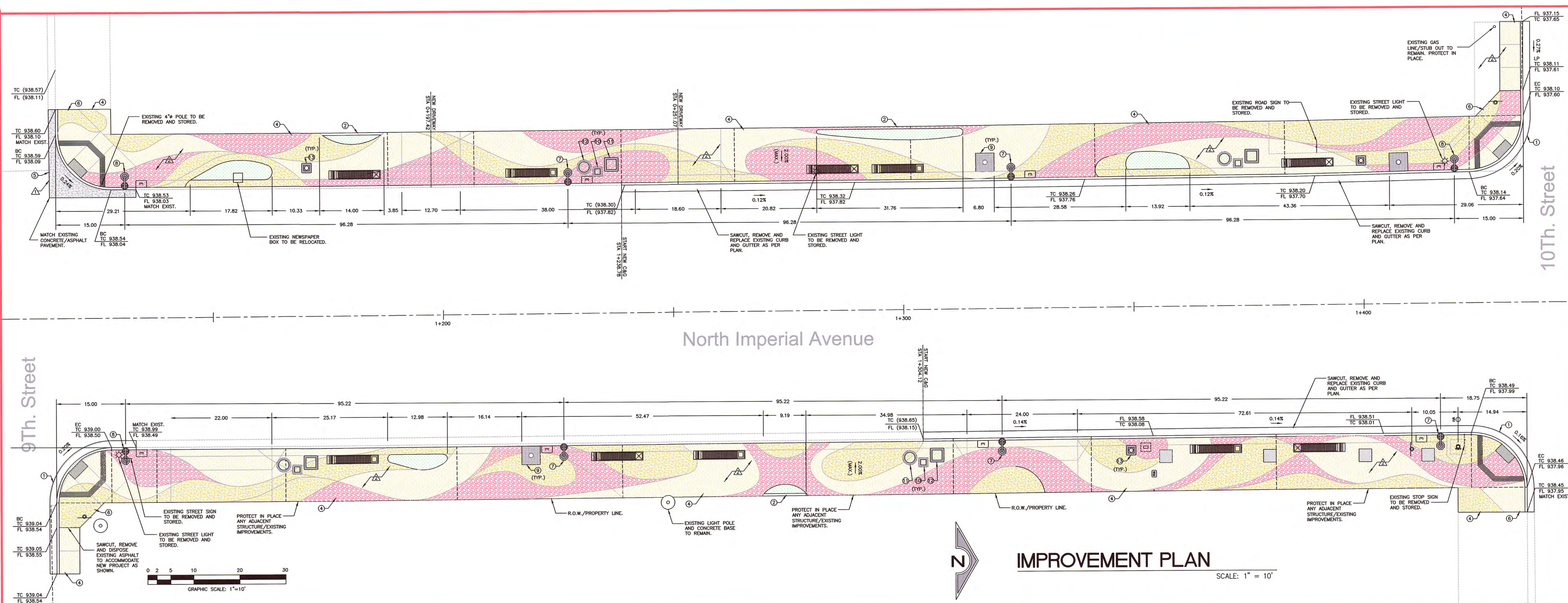

LEGEND					
SYMBOL	DESCRIPTION	SYMBOL	DESCRIPTION	SYMBOL	DESCRIPTION
	NEW STANDARD PCC CONCRETE SURFACE. SEE KEYNOTE NO. 5.		ALIGNMENT LINE		NEW 48" X 48" TREE WELL AND GRATE. SEE KEYNOTE NO. 9.
	NEW SANGRIA COLOR EXPOSED PEA GRAVEL AGGREGATE PCC CONCRETE SURFACE. SEE KEYNOTE NO. 4.		PROPERTY / RIGHT OF WAY LINE		NEW 37" X 25" ROUND PLANTER. SEE KEYNOTE NO. 12.
	NEW MESA BUFF COLOR EXPOSED PEA GRAVEL AGGREGATE PCC CONCRETE SURFACE. SEE KEYNOTE NO. 4.		NEW OFF-SITE IMPROVEMENTS		NEW 36" X 30" SQUARE PLANTER. SEE KEYNOTE NO. 11.
	NEW ADOBE COLOR EXPOSED PEA GRAVEL AGGREGATE PCC CONCRETE SURFACE. SEE KEYNOTE NO. 4.		EXISTING OFF-SITE IMPROVEMENTS		NEW 24" X 22" SQUARE PLANTER. SEE KEYNOTE NO. 10.
	NEW OPEN LANDSCAPE AREA.		NEW 3" EXPANSION JOINT		27 GAL. TRASH RECEPTACLE SHELL. SEE KEYNOTE NO. 13.
	NEW ASPHALT-RUBBER AGGREGATE MEMBRANE PAVEMENT TO BE INSTALLED.		NEW STOP SIGN		NEW WOOD FRAME STUCCO BENCH TYPE 1.
	NEW PCC CURB AND GUTTER. SEE KEYNOTE NO. 1.		NEW STREET LIGHT. SEE KEYNOTES NO. 7 AND 8.		NEW WOOD FRAME STUCCO BENCH TYPE 2.
	NEW 6" X 18" PCC FREE STANDING CURB. SEE KEYNOTE NO. 2.		EXISTING POLE		
			EXISTING STREET LIGHT		
			EXISTING WATER METER		
			EXISTING WATER VALVE		
			EXISTING FIRE HYDRANT		
			EXISTING ELECTRICAL STUB-OUT/PREP.		

CONSTRUCTION KEYNOTES		DEMOLITION KEYNOTES	
1	INSTALL NEW PCC CURB AND GUTTER AS PER CITY OF IMPERIAL STD. DETAIL NO. 21.		SAWCUT, REMOVE AND DISPOSE EXISTING PCC APRON. SAWCUT, REMOVE AND REPLACE ADJACENT EXISTING AC PAVEMENT AS NECESSARY. COORDINATE WITH CITY ENGINEERING DEPT. STAFF.
2	INSTALL NEW 6" X 18" PCC FREE STANDING CURB. REFER TO TECHNICAL SPECIFICATIONS AS PER CITY OF IMPERIAL STD. DETAIL NO. 21. COORDINATE WITH CITY ENGINEERING DEPT. STAFF.		REMOVE AND DISPOSE EXISTING PCC SIDEWALK, DRIVEWAY APPROACHES AND HANDICAP RAMPS. PROTECT IN PLACE ADJACENT IMPROVEMENTS AND/OR STRUCTURES. SAWCUT AS NECESSARY.
3	INSTALL NEW PCC SIDEWALK AS PER CITY OF IMPERIAL STD. DETAIL NO. 25. REFER TO COLOR CODE AND FINISH AS PER THIS SET OF PLANS.		
4	INSTALL NEW 12" WIDE PCC SIDEWALK. REFER TO TECHNICAL SPECIFICATIONS AS PER CITY OF IMPERIAL STD. DETAIL NO. 21 UNLESS OTHERWISE NOTED. COORDINATE WITH CITY ENGINEERING DEPT. STAFF. REFER TO COLOR CODE AND FINISH AS PER THIS SET OF PLANS.		
5	INSTALL NEW 6" THICK 4,500 PSI PCC CONCRETE SPANDREL MATCH EXISTING ASPHALT/CONCRETE SURFACE UNLESS OTHERWISE NOTED. CONCRETE MIX SHALL CONTAIN 1-1/2 LBS. OF POLYPROPYLENE FIBER PER CUBIC YARD. COORDINATE WITH CITY ENGINEERING DEPT. STAFF.		
6	INSTALL NEW HANDICAP RAMP. REFER TO TECHNICAL SPECIFICATIONS AS PER CITY OF IMPERIAL STD. DETAIL NO. 23 UNLESS OTHERWISE NOTED. COORDINATE WITH CITY ENGINEERING DEPT. STAFF. REFER TO COLOR CODE AND FINISH AS PER THIS SET OF PLANS.		
7	NEW 22" CLASS B ROSEMOUNT II STREET LIGHT BY SKY CAST INC. IMPERIAL, CA POLE TYPE, CALITE DWG# SC 220 BR2 NSE DTG P.		
8	NEW 27" CLASS B ROSEMOUNT II STREET LIGHT BY SKY CAST INC. IMPERIAL, CA POLE TYPE, CALITE DWG# SC 270 BR2 NSE DTG P.		
9	NEW 48" SQUARE "DIN" TREE GRATE BY OLYMPIC FOUNDRY INC. PART NO. 80-99, RATING N-A, TWO PIECE SET, 3" THICK GRATE.		
10	NEW 24" X 22" SQUARE PLANTER, IMPERIAL BY SAN DIEGO PRECAST CONCRETE INC. PART NO. P2422SQ-IMP, 540 LBS. 6,000 PSI.		
11	NEW 36" X 30" SQUARE PLANTER, IMPERIAL BY SAN DIEGO PRECAST CONCRETE INC. PART NO. P3630SQ-IMP, 1,235 LBS. 6,000 PSI.		
12	NEW 37" X 25" ROUND MEDITERRANEAN PLANTER, BY SAN DIEGO PRECAST CONCRETE INC. PART NO. P3725MOT, 780 LBS. 6,000 PSI.		
13	NEW 27 GAL. SQUARE TRASH RECEPTACLE SHELL, BY SAN DIEGO PRECAST CONCRETE INC. PART NO. HD06-TR27SQMOD, 1,020 LBS. 6,000 PSI. TRASH RECEPTACLE TO HAVE RECESSED PANELS ON 4 SIDES.		

SPECIAL NOTES	
NOTES: 1.- EXCEPTING BY THE STREET LIGHT POLES INSTALLATION; ALL OTHER ELECTRICAL WORK TO BE PERFORMED BY THE CITY OF IMPERIAL PUBLIC SERVICES DEPARTMENT. ALL SUPPLIES AND MATERIALS BY THE CITY OF IMPERIAL. ALL RELATED EQUIPMENT NEEDED FOR STREET LIGHT POLES INSTALLATION TO BE CONTRACTOR'S RESPONSIBILITY. CONTRACTOR TO COORDINATE WITH CITY OF IMPERIAL STAFF. 2.- TREE GRATES AND FRAMES TO BE SUPPLIED BY THE CITY OF IMPERIAL; CONTRACTOR TO BE RESPONSIBLE FOR THE INSTALLATION AND ALL OTHER MATERIAL AND EQUIPMENT. 3.- ALL PLANTERS, TRASH RECEPTACLES AND BENCHES TO BE SUPPLIED AND INSTALLED BY THE CITY OF IMPERIAL STAFF. 4.- ALL IRRIGATION WORK BY THE CITY OF IMPERIAL PUBLIC SERVICES DEPARTMENT; CONTRACTOR TO COORDINATE WITH CITY OF IMPERIAL STAFF.	



REVISIONS				BY:
NO.	DESCRIPTION:	DATE:	BY:	ROBERTO C. MARTINEZ
1				653 W. MAIN ST. SUITE 103
2				EL CENTRO, CA 92243
3				DATE: 05/14/15
4				R.C.E. NO. C-74475

IP2

CITY OF IMPERIAL DOWNTOWN BEAUTIFICATION PROJECT  
IMPERIAL AVE. FROM 6TH TO 7TH AND 9TH TO 10TH STREETS  
IMPROVEMENT PLANS

IN THE CITY OF IMPERIAL, CALIFORNIA

SHEET: 3

OF: 3

DWN. BY: A.A.

REV. BY: J.V.

APPD. BY: J.G.

DATE: 11/11/15