

DATE SUBMITTED 04/10/2019
 SUBMITTED BY COMMUNITY DEVELOPMENT DIRECTOR
 DATE ACTION REQUIRED 04/17/2019

COUNCIL ACTION (X)
 PUBLIC HEARING REQUIRED ()
 RESOLUTION ()
 ORDINANCE 1ST READING ()
 ORDINANCE 2ND READING ()
 CITY CLERK'S INITIALS Ø

**IMPERIAL CITY COUNCIL
 AGENDA ITEM**

SUBJECT: DISCUSSION/ACTION: ATEN BOULEVARD & CROSS ROAD INTERSECTION IMPROVEMENTS 1. AUTHORIZATION TO SEEK BIDS	
DEPARTMENT INVOLVED: COMMUNITY DEVELOPMENT DEPARTMENT	
BACKGROUND/SUMMARY: The opening of Cross Elementary will increase pedestrian and vehicular traffic at the intersection of Aten Boulevard and Cross Road. The increase of vehicular traffic exposes both pedestrians and bicycle riders to risk. In order to enhance the safety of our community, the City is requesting authorization to seek bids for Aten Boulevard & Cross Road intersection improvements, which consist of approximately of sidewalk, curb and gutter, upgrading existing traffic signal hardware by installing new pedestrian countdown signal heads, accessible pedestrian signal (APS) push buttons, asphalt road resurfacing plans, and ADA compliant curb ramps and crosswalk striping. <i>See Exhibit 'A' attached hereto for details.</i>	
FISCAL IMPACT: \$440,380 from LTA MEASURE 'D'	ADMIN SERVICES SIGN INITIALS <u>Ø</u>
STAFF RECOMMENDATION: Authorization to seek bids.	DEPT. INITIALS <u>ØM</u>
MANAGER'S RECOMMENDATION:	CITY MANAGER'S INITIALS _____
MOTION:	
SECONDED: AYES: NAYES: ABSENT:	APPROVED () REJECTED () DISAPPROVED () DEFERRED () REFERRED TO:



NOTE:
PHOTOGRAPHIC BACKGROUND
IS FOR REFERENCE ONLY.
SCALE IS APPROXIMATE.

	COMMUNITY DEVELOPMENT DEPARTMENT EXHIBIT 'A' PROJECT SITE ATEN BLVD & CROSS RD INTERSECTION		SHEET 1 of 1 SHEETS
	400 South Imperial Avenue, Suite 101 Imperial, CA 92251 Ph: (760) 355-3840 • Fax: (760) 355-4718		DATE: 07/18/2019

VICINITY MAP



PROJECT AREA



DECLARATION OF RESPONSIBLE CHARGE

I, THE UNDERSIGNED, HAVE BEEN THE DESIGNER OF RECORD FOR THIS PROJECT THAT I HAVE EXERCISED RESPONSIBILITY OVER THE BUSINESS AND STANDARDS SPECIFICATIONS BY THE CITY OF IMPERIAL IS CONTAINED IN A REVIEW ONLY AND DOES NOT RELIEVE ME, AS ENGINEER OF WORK, OF MY RESPONSIBILITIES FOR THE PROJECT DESIGN.

CARLOS BELTRAN, P.E. ENGINEERS, INC.
2415 IMPERIAL BUSINESS PARK DR STE B
IMPERIAL, CA 92521
(760) 549-0102

CARLOS BELTRAN, P.E.
DATE

BENCH MARKS:

APPROVED	DATE

PROJECT INFORMATION

OWNER
CITY OF IMPERIAL
420 S. IMPERIAL AVENUE
IMPERIAL, CA 92521
TEL: (760) 355-3946

ENGINEER
DYNAMIC CONSULTING ENGINEERS, INC.
1000 S. IMPERIAL BUSINESS PARK DR STE B
IMPERIAL, CA 92521
TEL: (760) 548-0182
FAX: (760) 548-0183

STREET IMPROVEMENT GENERAL NOTES

- THE APPROVED PLANS AND SPECIFICATIONS PREVAIL OVER ANY PREVIOUS SPIN OFF DRAWINGS.
- THE STRUCTURAL SECTION SHALL BE IN ACCORDANCE WITH CITY OF IMPERIAL STANDARDS FOR CONCRETE IN A STATE ROOM AND AS APPROVED BY THE CITY ENGINEERING DEPARTMENT.
- APPROVAL OF THESE IMPROVEMENT PLANS AS SHOWN DOES NOT CONSTITUTE APPROVAL OF ANY CONSTRUCTION DURING THE PROJECT PERIOD.
- CONSTRUCTION SHALL BE IN ACCORDANCE WITH THE CITY OF IMPERIAL STANDARDS FOR CONCRETE IN A STATE ROOM AND AS APPROVED BY THE CITY ENGINEERING DEPARTMENT.
- APPROVAL OF THESE IMPROVEMENT PLANS AS SHOWN DOES NOT CONSTITUTE APPROVAL OF ANY CONSTRUCTION DURING THE PROJECT PERIOD.
- CONSTRUCTION SHALL BE IN ACCORDANCE WITH THE CITY OF IMPERIAL STANDARDS FOR CONCRETE IN A STATE ROOM AND AS APPROVED BY THE CITY ENGINEERING DEPARTMENT.

AGENCY CONTACTS

CITY OF IMPERIAL
CITY ENGINEER
ARMANDO AMPARANO
3111 IMPERIAL BLVD
IMPERIAL, CA 92521
PHONE: 760-355-1041

CITY OF IMPERIAL
CITY PLANNER
OTTHON MORAN
3111 IMPERIAL BLVD
IMPERIAL, CA 92521
PHONE: 760-355-1041

CITY OF IMPERIAL
CITY CLERK
DEBRA JACKSON
3111 IMPERIAL BLVD
IMPERIAL, CA 92521
PHONE: 760-355-1041

AGENCY CONTACTS

ARMANDO AMPARANO
CITY ENGINEER
3111 IMPERIAL BLVD
IMPERIAL, CA 92521
PHONE: 760-355-1041

OTTHON MORAN
CITY PLANNER
3111 IMPERIAL BLVD
IMPERIAL, CA 92521
PHONE: 760-355-1041

DEBRA JACKSON
CITY CLERK
3111 IMPERIAL BLVD
IMPERIAL, CA 92521
PHONE: 760-355-1041

SHEET INDEX

1 TITLE SHEET VICINITY MAP AND GENERAL NOTES
2 DEMOLITION PLANS STA 12+48 TO STA 14+00
3 EXISTING AND PROPOSED PLAN STA 14+00 TO STA 22+00
4 DEMOLITION PLANS STA 22+00 TO STA 24+00
5 IMPROVEMENT PLANS STA 24+00 TO STA 14+00
6 IMPROVEMENT PLANS STA 14+00 TO STA 22+00
7 IMPROVEMENT PLANS STA 22+00 TO STA 24+00
8 STRENGTH PLAN
9 STRENGTH PLAN
10 DETAIL SHEET

APRIL 2019

NOTE TO CONTRACTOR

THE CONTRACTOR SHALL BE RESPONSIBLE FOR OBTAINING ALL NECESSARY PERMITS AND APPROVALS FROM THE CITY OF IMPERIAL AND THE CALIFORNIA DEPARTMENT OF PUBLIC WORKS. THE CONTRACTOR SHALL BE RESPONSIBLE FOR OBTAINING ALL NECESSARY PERMITS AND APPROVALS FROM THE CITY OF IMPERIAL AND THE CALIFORNIA DEPARTMENT OF PUBLIC WORKS. THE CONTRACTOR SHALL BE RESPONSIBLE FOR OBTAINING ALL NECESSARY PERMITS AND APPROVALS FROM THE CITY OF IMPERIAL AND THE CALIFORNIA DEPARTMENT OF PUBLIC WORKS.

ENGINEER'S NOTE TO CONTRACTOR

THE CONTRACTOR SHALL BE RESPONSIBLE FOR OBTAINING ALL NECESSARY PERMITS AND APPROVALS FROM THE CITY OF IMPERIAL AND THE CALIFORNIA DEPARTMENT OF PUBLIC WORKS. THE CONTRACTOR SHALL BE RESPONSIBLE FOR OBTAINING ALL NECESSARY PERMITS AND APPROVALS FROM THE CITY OF IMPERIAL AND THE CALIFORNIA DEPARTMENT OF PUBLIC WORKS. THE CONTRACTOR SHALL BE RESPONSIBLE FOR OBTAINING ALL NECESSARY PERMITS AND APPROVALS FROM THE CITY OF IMPERIAL AND THE CALIFORNIA DEPARTMENT OF PUBLIC WORKS.

CITY COUNCIL

ROBERT AMPARANO
CITY CLERK

DARRELL PECHTL
CITY CLERK

GEOFF DALE
CITY CLERK

KARIN EUGENIO
CITY CLERK

JAMES TUCKER
CITY CLERK

PARTICIPATING CITY STAFF

BREFFANT T. CHARTWIN
CITY CLERK

DEBRA JACKSON
CITY CLERK

OTTHON MORAN
CITY PLANNER

STACY COX
CITY TREASURER

JESSIE VILLEGAS
ENGINEERING MANAGER

ARMANDO AMPARANO
ENGINEERING MANAGER

STREET IMPROVEMENT GENERAL NOTES

- ALL SIGNS TO BE ALUMINUM WITH 3M HIGH INTENSITY TYPE REFLECTIVE FACE OR EQUIVALENT.
- CONTRACTOR SHALL BE RESPONSIBLE FOR THE REPAIRMENT OF ANY STRIPPING, PREVENT WEAR, OR LESIONS SUSTAINED BY THE CONSTRUCTION OF THIS PROJECT.
- THE CONTRACTOR SHALL BE RESPONSIBLE FOR OBTAINING ALL NECESSARY PERMITS AND APPROVALS FROM THE CITY OF IMPERIAL AND THE CALIFORNIA DEPARTMENT OF PUBLIC WORKS. THE CONTRACTOR SHALL BE RESPONSIBLE FOR OBTAINING ALL NECESSARY PERMITS AND APPROVALS FROM THE CITY OF IMPERIAL AND THE CALIFORNIA DEPARTMENT OF PUBLIC WORKS.
- THE CONTRACTOR SHALL BE RESPONSIBLE FOR OBTAINING ALL NECESSARY PERMITS AND APPROVALS FROM THE CITY OF IMPERIAL AND THE CALIFORNIA DEPARTMENT OF PUBLIC WORKS. THE CONTRACTOR SHALL BE RESPONSIBLE FOR OBTAINING ALL NECESSARY PERMITS AND APPROVALS FROM THE CITY OF IMPERIAL AND THE CALIFORNIA DEPARTMENT OF PUBLIC WORKS.
- THE CONTRACTOR SHALL BE RESPONSIBLE FOR OBTAINING ALL NECESSARY PERMITS AND APPROVALS FROM THE CITY OF IMPERIAL AND THE CALIFORNIA DEPARTMENT OF PUBLIC WORKS. THE CONTRACTOR SHALL BE RESPONSIBLE FOR OBTAINING ALL NECESSARY PERMITS AND APPROVALS FROM THE CITY OF IMPERIAL AND THE CALIFORNIA DEPARTMENT OF PUBLIC WORKS.
- THE CONTRACTOR SHALL BE RESPONSIBLE FOR OBTAINING ALL NECESSARY PERMITS AND APPROVALS FROM THE CITY OF IMPERIAL AND THE CALIFORNIA DEPARTMENT OF PUBLIC WORKS. THE CONTRACTOR SHALL BE RESPONSIBLE FOR OBTAINING ALL NECESSARY PERMITS AND APPROVALS FROM THE CITY OF IMPERIAL AND THE CALIFORNIA DEPARTMENT OF PUBLIC WORKS.

DECLARATION OF RESPONSIBLE CHARGE

I, THE UNDERSIGNED, HAVE BEEN THE DESIGNER OF RECORD FOR THIS PROJECT THAT I HAVE EXERCISED RESPONSIBILITY OVER THE BUSINESS AND STANDARDS SPECIFICATIONS BY THE CITY OF IMPERIAL IS CONTAINED IN A REVIEW ONLY AND DOES NOT RELIEVE ME, AS ENGINEER OF WORK, OF MY RESPONSIBILITIES FOR THE PROJECT DESIGN.

CARLOS BELTRAN, P.E. ENGINEERS, INC.
2415 IMPERIAL BUSINESS PARK DR STE B
IMPERIAL, CA 92521
(760) 549-0102

CARLOS BELTRAN, P.E.
DATE

BENCH MARKS:

APPROVED	DATE

DYNAMIC CONSULTING ENGINEERS

1000 S. IMPERIAL BUSINESS PARK DR STE B
IMPERIAL, CA 92521
TEL: (760) 548-0182 FAX: (760) 548-0183

PROJECT TITLE: CITY OF IMPERIAL - ATEN BOULEVARD & CROSS ROAD INTERSECTION IMPROVEMENTS

SHEET: 1 OF 10 SHEETS

TITLE SHEET VICINITY MAP AND GENERAL NOTES

DATE: APRIL 10, 2019

PROJECT NO: 88121
R.C.E. NO: 06/19/20
REG. EXP. DATE:

BENCH MARK:

RECORDING LOCATION - 88121-001 (881+000)

RECORDING METHOD - BENCHMARK

RECORDING DATE - 06/19/20

RECORDING TIME - 10:00 AM

RECORDING LOCATION - 88121-001 (881+000)

RECORDING METHOD - BENCHMARK

RECORDING DATE - 06/19/20

RECORDING TIME - 10:00 AM

CITY OF IMPERIAL

420 South Imperial Avenue
Imperial, CA 92521
Ph: (760) 355-3840 • Fax: (760) 355-4718

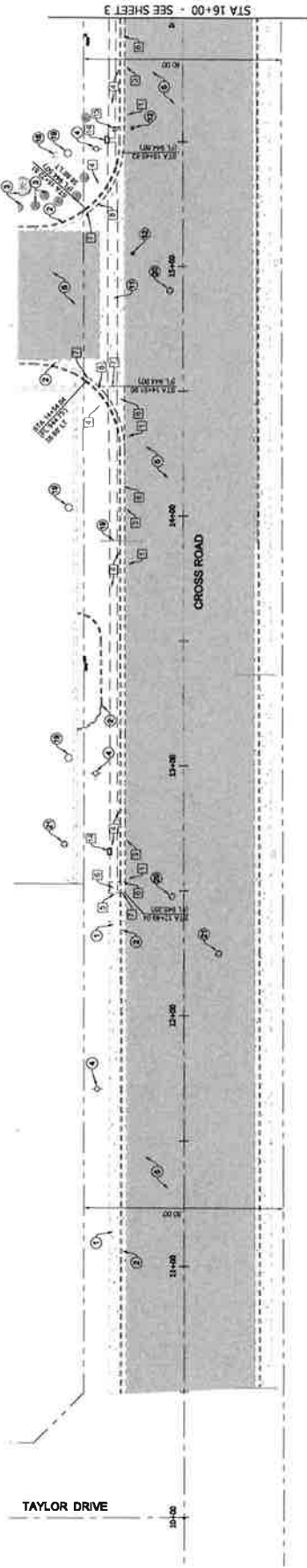

PLAN VIEW

- DEMOLITION KEYNOTES**
- 1 REMOVE AND DISPOSE OF EXISTING A/C PAVEMENT FOR THE FULL DEPTH OF THE A/C PAVEMENT
 - 2 REMOVE AND DISPOSE OF EXISTING A/C PAVEMENT FOR A THICKNESS OF 2 INCHES
 - 3 REMOVE AND DISPOSE OF EXISTING A/C PAVEMENT AND UNDERLYING
 - 4 REPAIR AND DISPOSE OF EXISTING A/C PAVEMENT AND UNDERLYING TO SUBBASE DESIGN GRADE
 - 5 GRADE AND DISPOSE OF EXISTING INERTIVE MATERIAL TO SUBBASE DESIGN GRADE
 - 6 SAWCUT THE EXISTING P/C C SIDEWALK FOR THE FULL DEPTH OF THE P/C SIDEWALK
 - 7 REMOVE AND DISPOSE OF EXISTING P/C C SIDEWALK AND UNDERLYING
 - 8 REMOVE AND DISPOSE OF EXISTING P/C C CURBS AND GUTTER AND UNDERLYING MATERIAL TO SUBBASE DESIGN GRADE
 - 9 SAWCUT THE EXISTING P/C C CURBS AND GUTTER AND UNDERLYING MATERIAL TO SUBBASE DESIGN GRADE
 - 10 REMOVE AND DISPOSE OF EXISTING P/C C DRIVEWAY, INCLUDING REPAIRS AND UNDERLYING MATERIAL TO SUBBASE DESIGN GRADE
 - 11 CONTRACTOR TO LOWER THE WATER VALVE RESET TO 36 FEET BELOW GRADE PRIOR TO PAWS ACTIVITIES. SEE DETAIL XX ON SHEET XX.
 - 12 REMOVE AND RELOCATE EXISTING GUY WIRE BY OTHERS
 - 13 REMOVE AND RELOCATE EXISTING GUY WIRE TO PAWS ACTIVITIES. SEE DETAIL XX ON SHEET XX.
 - 14 CONTRACTOR TO LOWER THE EXISTING MANHOLE TO 36 FEET BELOW GRADE PRIOR TO PAWS ACTIVITIES. SEE DETAIL XX ON SHEET XX.
 - 15 REMOVE AND RELOCATE EXISTING 18" EMBLEM BY OTHERS
 - 16 REMOVE AND RELOCATE EXISTING FIRE HYDRANT ASSEMBLY PER DETAIL 13 ON SHEET XX.
- EXISTING FACILITY KEYNOTES**
- 1 EXISTING SIDEWALK TO REMAIN
 - 2 EXISTING CURB AND GUTTER TO REMAIN
 - 3 EXISTING TREE/PALM TO REMAIN
 - 4 EXISTING POWER/TELEPHONE POLE TO REMAIN
 - 5 EXISTING A/C PAVEMENT TO REMAIN
 - 6 EXISTING SIGN TO REMAIN
 - 7 EXISTING DRIVEWAY TO REMAIN
 - 8 EXISTING FIRE HYDRANT TO REMAIN (PROTECT IN PLACE)
 - 9 EXISTING WATER METER TO REMAIN
 - 10 EXISTING GUY WIRE TO REMAIN
 - 11 EXISTING CROSS GUTTER TO REMAIN
 - 12 EXISTING WATER VALVE TO REMAIN
 - 13 EXISTING SIDEWALK TO REMAIN
 - 14 EXISTING WATER LINE TO REMAIN
 - 15 EXISTING AT&T LINE TO REMAIN
 - 16 EXISTING UTILITY BOX TO REMAIN
 - 17 EXISTING EDGE OF PAVEMENT
 - 18 EXISTING P/C C MANHOLE/CURB MARK TO REMAIN
 - 19 EXISTING ELECTRICAL LIGHT POLE TO REMAIN
 - 20 EXISTING SEWER MANHOLE TO REMAIN
 - 21 EXISTING STORM DRAIN MANHOLE TO REMAIN

NOTE:
 THE EXACT HORIZONTAL AND VERTICAL LOCATIONS OF THE EXISTING UNDERGROUND UTILITIES ARE UNKNOWN. THE EXISTING UNDERGROUND UTILITIES ARE SHOWN AS-LOCATED. SANITARY SEWER LATERALS AND WATER SERVICE LATERALS ARE UNKNOWN AND NOT ILLUSTRATED ON THE PLANS. AN EFFORT WAS MADE TO OBTAIN AS-BUILT PLANS IN ORDER TO VERIFY THE EXACT HORIZONTAL AND VERTICAL LOCATIONS OF THE UTILITIES. HOWEVER, THERE MAY BE ADDITIONAL UNDERGROUND UTILITIES NOT ILLUSTRATED ON THESE PLANS. CONTRACTOR SHALL "POI-HOLE" THE EXISTING UNDERGROUND UTILITIES WITHIN THE LIMITS OF THE PROJECT TO VERIFY THE EXACT HORIZONTAL AND VERTICAL LOCATIONS. THE ISSUANCE OF THE NOTICES TO PROCEED, THE CONTRACTOR SHALL BE RESPONSIBLE FOR THE LOCATION OF ALL UTILITIES. THE CONTRACTOR SHALL BE RESPONSIBLE FOR THE LOCATION OF ALL UTILITIES. THE CONTRACTOR SHALL BE RESPONSIBLE FOR THE LOCATION OF ALL UTILITIES. THE CONTRACTOR SHALL BE RESPONSIBLE FOR THE LOCATION OF ALL UTILITIES.

NO. ENGINEER APPROVED DATE

UNAUTHORIZED CHANGES & USES. The engineer preparing these plans and seal is responsible for the accuracy of the information shown on these plans. All changes to the plans must be made on a separate sheet and approved by the engineer of these plans.



CITY OF IMPERIAL
 420 South Imperial Avenue
 Imperial, CA 92251
 Ph: (760) 355-3840 • Fax: (760) 355-4718

BENCH MARK:
 BENCHMARK ELEVATION = 830.32 (NAD 83 + 1000)
 BENCHMARK DESCRIPTION: 100mm x 100mm x 100mm
 100mm x 100mm x 100mm
 100mm x 100mm x 100mm
 100mm x 100mm x 100mm



PREPARED UNDER THE DIRECT SUPERVISION OF
 SCALE 1" = 20'
 SCALE 1" = 80'
 DATE: APR. 10, 2019

DYNAMIC CONSULTING ENGINEERS
 5000 SANDHILL DRIVE, SUITE 100
 IMPERIAL, CA 92251
 TEL: (760) 355-3840 • FAX: (760) 355-4718

PROJECT TITLE: ATEN BOULEVARD & CROSS ROAD INTERSECTION IMPROVEMENTS
 SHEET CONTENTS: STREET IMPROVEMENTS CROSS ROAD STA 12+79.32 TO STA 16+00

SCALE: 1" = 80' 1/4"
 DRAWN BY: CB
 REVISIONS: CB
 SHEET NO. OF 10 SHEETS
 DATE: APR. 10, 2019

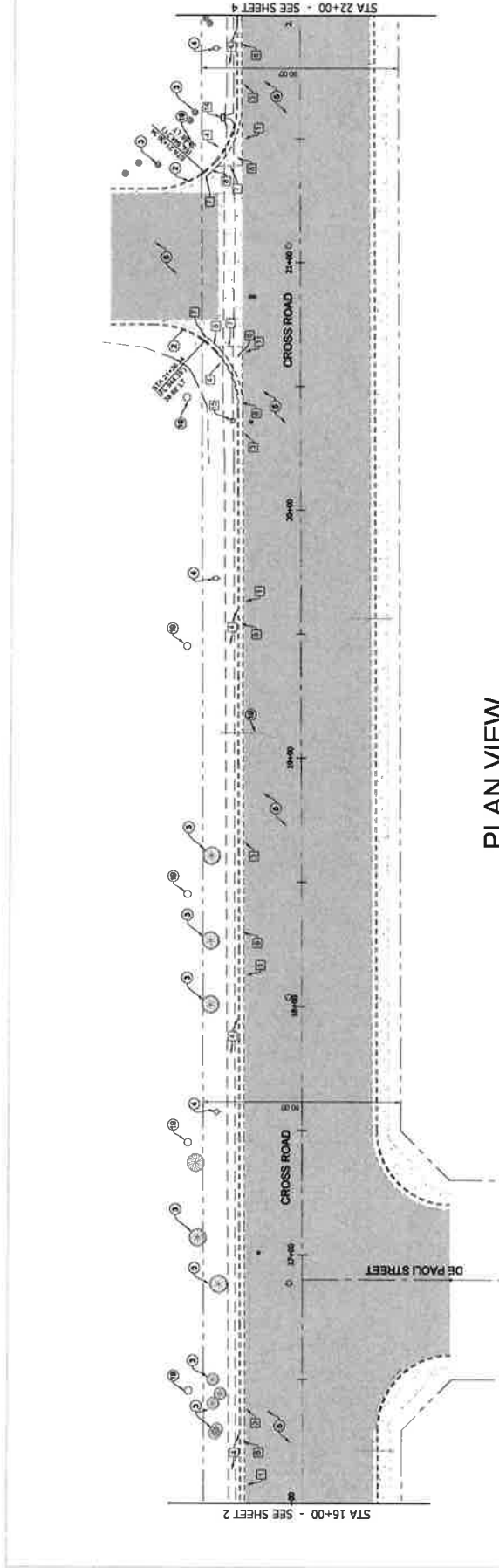

PLAN VIEW

- DEMOLITION KEYNOTES**
- 1 SAW CUT THE EXISTING A/C PAVEMENT FOR THE FULL DEPTH OF THE A/C
 - 2 CO PLAN EXISTING A/C PAVEMENT FOR A THICKNESS OF 3 INCHES
 - 3 REMOVE AND DISPOSE OF EXISTING A/C PAVEMENT MATERIAL
 - 4 REMOVE AND DISPOSE OF EXISTING A/C PAVEMENT AND UNDERLYING MATERIAL TO SUBBASE DESIGN GRADE
 - 5 GRADE AND DISPOSE OF EXISTING NATIVE MATERIAL TO SUBBASE DESIGN GRADE
 - 6 SAW CUT THE EXISTING P/C C SIDEWALK FOR THE FULL DEPTH OF THE P/C C SIDEWALK
 - 7 REMOVE AND DISPOSE OF EXISTING P/C C SIDEWALK AND UNDERLYING MATERIAL TO DESIGN SUBBASE GRADE
 - 8 REMOVE AND DISPOSE OF EXISTING P/C C CURB AND GUTTER AND UNDERLYING MATERIAL TO DESIGN SUBBASE GRADE
 - 9 REMOVE AND DISPOSE OF EXISTING P/C C CURB AND GUTTER AND UNDERLYING MATERIAL TO DESIGN SUBBASE GRADE
 - 10 REMOVE AND DISPOSE OF EXISTING P/C C CURB AND GUTTER AND UNDERLYING MATERIAL TO DESIGN SUBBASE GRADE
 - 11 REMOVE AND DISPOSE OF EXISTING P/C C CURB AND GUTTER AND UNDERLYING MATERIAL TO DESIGN SUBBASE GRADE
 - 12 REMOVE AND DISPOSE OF EXISTING P/C C CURB AND GUTTER AND UNDERLYING MATERIAL TO DESIGN SUBBASE GRADE
 - 13 REMOVE AND DISPOSE OF EXISTING P/C C CURB AND GUTTER AND UNDERLYING MATERIAL TO DESIGN SUBBASE GRADE
 - 14 REMOVE AND DISPOSE OF EXISTING P/C C CURB AND GUTTER AND UNDERLYING MATERIAL TO DESIGN SUBBASE GRADE
 - 15 REMOVE AND DISPOSE OF EXISTING P/C C CURB AND GUTTER AND UNDERLYING MATERIAL TO DESIGN SUBBASE GRADE
 - 16 REMOVE AND DISPOSE OF EXISTING P/C C CURB AND GUTTER AND UNDERLYING MATERIAL TO DESIGN SUBBASE GRADE
 - 17 REMOVE AND DISPOSE OF EXISTING P/C C CURB AND GUTTER AND UNDERLYING MATERIAL TO DESIGN SUBBASE GRADE
 - 18 REMOVE AND DISPOSE OF EXISTING P/C C CURB AND GUTTER AND UNDERLYING MATERIAL TO DESIGN SUBBASE GRADE
 - 19 REMOVE AND DISPOSE OF EXISTING P/C C CURB AND GUTTER AND UNDERLYING MATERIAL TO DESIGN SUBBASE GRADE
 - 20 REMOVE AND DISPOSE OF EXISTING P/C C CURB AND GUTTER AND UNDERLYING MATERIAL TO DESIGN SUBBASE GRADE
 - 21 REMOVE AND DISPOSE OF EXISTING P/C C CURB AND GUTTER AND UNDERLYING MATERIAL TO DESIGN SUBBASE GRADE
 - 22 REMOVE AND DISPOSE OF EXISTING P/C C CURB AND GUTTER AND UNDERLYING MATERIAL TO DESIGN SUBBASE GRADE
 - 23 REMOVE AND DISPOSE OF EXISTING P/C C CURB AND GUTTER AND UNDERLYING MATERIAL TO DESIGN SUBBASE GRADE
 - 24 REMOVE AND DISPOSE OF EXISTING P/C C CURB AND GUTTER AND UNDERLYING MATERIAL TO DESIGN SUBBASE GRADE
- EXISTING FACILITY KEYNOTES**
- 1 EXISTING SIDEWALK TO REMAIN
 - 2 EXISTING CURB AND GUTTER TO REMAIN
 - 3 EXISTING TREE PALM TO REMAIN
 - 4 EXISTING POWER TELEPHONE POLE TO REMAIN
 - 5 EXISTING A/C PAVEMENT TO REMAIN
 - 6 EXISTING SIGN TO REMAIN
 - 7 EXISTING DRIVEWAY TO REMAIN
 - 8 EXISTING FIRE HYDRANT TO REMAIN (PROTECT IN PLACE)
 - 9 EXISTING WATER METER TO REMAIN
 - 10 EXISTING GUY WIRE TO REMAIN
 - 11 EXISTING CROSS GUTTER TO REMAIN
 - 12 EXISTING WATER VALVE TO REMAIN
 - 13 EXISTING BEMBER LINE TO REMAIN
 - 14 EXISTING WATER LINE TO REMAIN
 - 15 EXISTING AT & T LINE TO REMAIN
 - 16 EXISTING UTILITY BOX TO REMAIN
 - 17 EXISTING EDGE OF PAVEMENT
 - 18 EXISTING P/C C HANDICAP CURB RAMP TO REMAIN
 - 19 EXISTING ELECTRICAL LIGHT POLE TO REMAIN
 - 20 EXISTING SEWER MANHOLE TO REMAIN
 - 21 EXISTING STORM DRAIN MANHOLE TO REMAIN

NOTE:
 THE EXACT HORIZONTAL AND VERTICAL LOCATIONS OF THE EXISTING UNDERGROUND UTILITIES ARE NOT KNOWN. THE EXISTING UTILITIES ARE LOCATED AND IDENTIFIED BY THE CONTRACTOR USING THE INFORMATION PROVIDED IN THESE PLANS. THE CONTRACTOR SHALL VERIFY THE LOCATION AND DEPTH OF ALL UTILITIES PRIOR TO CONSTRUCTION. THE CONTRACTOR SHALL BE RESPONSIBLE FOR OBTAINING ALL NECESSARY PERMITS FROM THE LOCAL AGENCIES AND UTILITIES COMPANIES. THE CONTRACTOR SHALL BE RESPONSIBLE FOR PROTECTING ALL UTILITIES THAT ARE NOT TO BE REMOVED. THE CONTRACTOR SHALL BE RESPONSIBLE FOR OBTAINING ALL NECESSARY PERMITS FROM THE LOCAL AGENCIES AND UTILITIES COMPANIES. THE CONTRACTOR SHALL BE RESPONSIBLE FOR PROTECTING ALL UTILITIES THAT ARE NOT TO BE REMOVED. THE CONTRACTOR SHALL BE RESPONSIBLE FOR OBTAINING ALL NECESSARY PERMITS FROM THE LOCAL AGENCIES AND UTILITIES COMPANIES. THE CONTRACTOR SHALL BE RESPONSIBLE FOR PROTECTING ALL UTILITIES THAT ARE NOT TO BE REMOVED.



Dynamic CONSULTING ENGINEERS
 1000 WEST 10TH STREET, SUITE 100
 IMPERIAL, CA 92251
 TEL: (760) 355-3840 FAX: (760) 355-4718

PROJECT TITLE: CITY OF IMPERIAL - AVENUE BOULEVARD & CROSS ROAD INTERSECTION IMPROVEMENTS
 SCALE: AS SHOWN
 DRAWN BY: DBL/TN
 SHEET NO. OF 10 SHEETS: 3
 REVISED BY: CB
 SHEET CONTENT: STREET IMPROVEMENTS CROSS ROAD STA 12+79.32 TO STA 16+00
 DATE: APRIL 10, 2019
 DCE 391719

NO.	REVISIONS	APPROVED	DATE

UNAUTHORIZED CHANGES & USES: The engineer preparing these plans, and his/her representative, shall be responsible for the accuracy and completeness of these plans. All changes to the plans shall be made by the engineer and shall be approved by the engineer. All changes to the plans shall be made by the engineer and shall be approved by the engineer.

BENCH MARK:
 BENCH MARK ELEVATION = 343.35 (MVD 28+1000)
 BENCHMARK DESCRIPTION: 1" DIAMETER BENCH MARK
 20" SET A BENCH MARK 0.15 MILE
 SOUTH OF THE CENTERLINE OF THE ROADWAY
 IN THE TOP OF 1.0 FOOT SOUTH OF THE NORTH
 END OF THE 60" CONCRETE C&G MANHOLE

CITY OF IMPERIAL
 420 South Imperial Avenue
 Imperial, CA 92251
 Ph: (760) 355-3840 • Fax: (760) 355-4718

CITY OF IMPERIAL CALIF. 1906

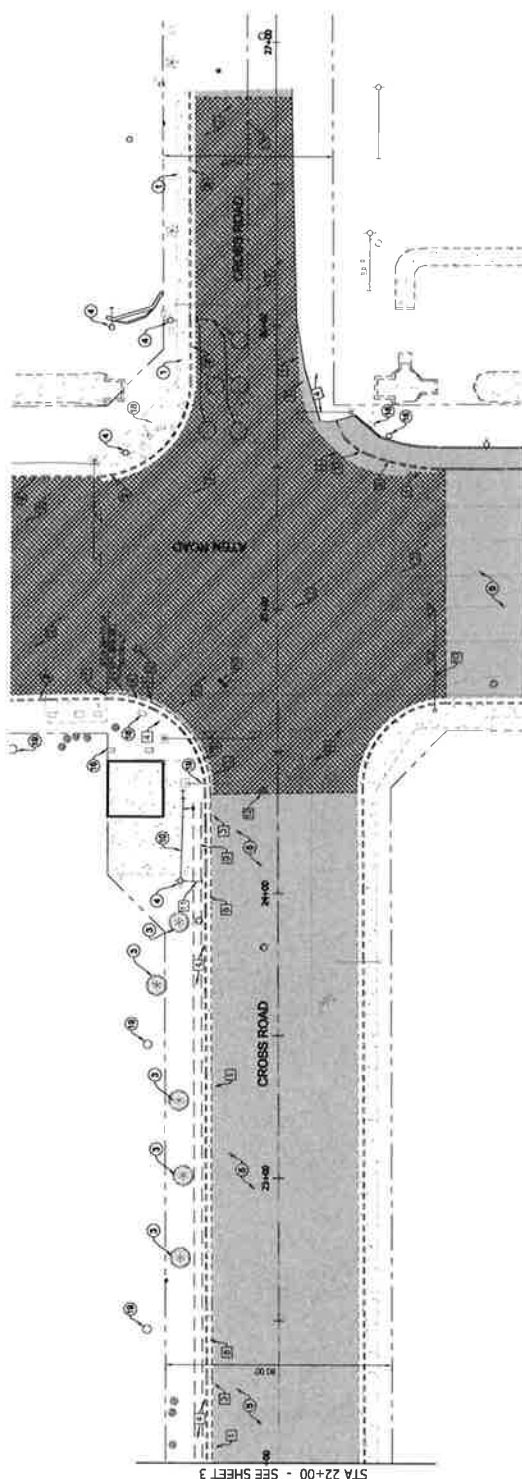

STA 22+00 - SEE SHEET 3

DEMOLITION KEYNOTES

- 1 SAWCUT THE EXISTING A/C PAVEMENT FOR THE FULL DEPTH OF THE A/C PAVEMENT
- 2 COLD PLANS EXISTING A/C PAVEMENT FOR A THICKNESS OF 2 INCHES
- 3 REMOVE AND DISPOSE OF EXISTING A/C PAVEMENT MATERIAL
- 4 REMOVE AND DISPOSE OF EXISTING A/C PAVEMENT AND UNDERLYING
- 5 REMOVE AND DISPOSE OF EXISTING NATIVE MATERIAL TO SUBBASE DESIGN
- 6 REMOVE AND DISPOSE OF EXISTING NATIVE MATERIAL TO SUBBASE DESIGN
- 7 SAWCUT THE EXISTING P.C.C. SIDEWALK FOR THE FULL DEPTH OF THE P.C.C. SIDEWALK
- 8 REMOVE AND DISPOSE OF EXISTING P.C.C. SIDEWALK AND UNDERLYING MATERIAL TO DESIGN SUBBASE GRADE
- 9 SAWCUT THE EXISTING P.C.C. CURB AND CUTTER AND/OR PORTION OF CROSS CURB FOR THE FULL DEPTH OF THE P.C.C. CURB AND CUTTER AND/OR UNDERLYING MATERIAL TO DESIGN SUBBASE GRADE
- 10 REMOVE AND DISPOSE OF EXISTING P.C.C. CURB AND CUTTER AND UNDERLYING MATERIAL TO DESIGN SUBBASE GRADE
- 11 REMOVE AND DISPOSE OF EXISTING P.C.C. DRIVEWAY INCLUDING REBARS
- 12 GRADE FLOOR TO FINISH THE WATER VALVE RISER TO 30 FEET BELOW EXISTING FINISH GRADE
- 13 REMOVE AND RELOCATE EXISTING SANITARY SEWER MANHOLE FRAME AND COVER TO 30 FEET BELOW GRADE PRIOR TO PAVING ACTIVITIES. SEE DETAIL 1-04 SHEET 'XX'
- 14 REMOVE AND RELOCATE EXISTING FIRE HYDRANT TO 30 FEET BELOW GRADE PRIOR TO PAVING ACTIVITIES. CONTRACTOR SHALL ADOPT THE EXISTING AND WITH COUNCIL OF IMPERIAL PRIOR TO CONSTRUCTION
- 15 REMOVE AND RELOCATE EXISTING FIRE HYDRANT ENCLOSURE BY OTHERS
- 16 REMOVE AND RELOCATE EXISTING FIRE HYDRANT ASSEMBLY PER DETAIL 'X' ON SHEET 'XX'

EXISTING FACILITY KEYNOTES

- 1 EXISTING SIDEWALK TO REMAIN
- 2 EXISTING CURB AND CUTTER TO REMAIN
- 3 EXISTING TELEPHONE POLE TO REMAIN
- 4 EXISTING POWER TELEPHONE POLE TO REMAIN
- 5 EXISTING A/C PAVEMENT TO REMAIN
- 6 EXISTING SIGN TO REMAIN
- 7 EXISTING FIRE HYDRANT TO REMAIN (PROTECT IN PLACE)
- 8 EXISTING WATER METER TO REMAIN
- 9 EXISTING GUY WIRE TO REMAIN
- 10 EXISTING WATER VALVE TO REMAIN
- 11 EXISTING WATER LINE TO REMAIN
- 12 EXISTING UTILITY BOX TO REMAIN
- 13 EXISTING AT-BIT LINE TO REMAIN
- 14 EXISTING EDGE OF PAVEMENT
- 15 EXISTING P.C.C. HANDICAP CURB RAMP TO REMAIN
- 16 EXISTING ELECTRICAL LIGHT POLE TO REMAIN
- 17 EXISTING SEWER MANHOLE TO REMAIN
- 18 EXISTING STORM DRAIN MANHOLE TO REMAIN

NOTE:
THE EXACT HORIZONTAL AND VERTICAL LOCATIONS OF THE EXISTING UNDERGROUND UTILITIES ARE NOT SHOWN ON THESE PLANS. THE EXISTING UNDERGROUND UTILITIES, SANITARY SEWER LATERALS, AND WATER SERVICE LATERALS ARE UNKNOWN AND NOT ILLUSTRATED ON THESE PLANS. AN EFFORT WAS MADE TO OBTAIN AS-BUILT PLANS IN ORDER TO ILLUSTRATE THE EXISTING UTILITIES. HOWEVER, THESE PLANS MAY NOT BE COMPLETELY ACCURATE. THE CONTRACTOR SHALL VERIFY THE LOCATION OF ALL UTILITIES WITHIN THE LIMITS OF THE PROJECT PRIOR TO CONSTRUCTION. THE CONTRACTOR SHALL BE RESPONSIBLE FOR OBTAINING ALL NECESSARY PERMITS FROM THE UTILITY COMPANIES AND CONSTRUCTION MANAGER. IT SHALL BE THE CONTRACTOR'S RESPONSIBILITY TO OBTAIN ALL NECESSARY PERMITS FROM THE UTILITY COMPANIES. THERE ARE EXISTING UNDERGROUND TELEPHONE CABLE, WATER, SANITARY SEWER, AND ELECTRICAL ALONG CROSS ROAD. THE CONTRACTOR SHALL VERIFY THE LOCATION OF ALL UTILITIES WITHIN THE LIMITS OF THE PROJECT PRIOR TO CONSTRUCTION. THE CONTRACTOR SHALL OBSERVE THE UTILITIES PRIOR TO DEMOLITION OF THE ROADWAY. PRELIMINARY OBSERVED AND IDENTIFIED UTILITIES ARE SHOWN ON THESE PLANS. THE CONTRACTOR SHALL BE RESPONSIBLE FOR VERIFYING THE LOCATION OF ALL UTILITIES PRIOR TO CONSTRUCTION. THE CONTRACTOR SHALL BE RESPONSIBLE FOR VERIFYING THE LOCATION OF ALL UTILITIES PRIOR TO CONSTRUCTION.



Dynamic ENGINEERS CONSULTING
 420 SOUTH IMPERIAL AVENUE, SUITE 200
 IMPERIAL, CA 92251
 TEL: (760) 355-3840 FAX: (760) 355-4718

NO. REVISIONS	APPROVED	DATE

PROJECT TITLE: CITY OF IMPERIAL - ATEN BOULEVARD & CROSS ROAD INTERSECTION IMPROVEMENTS
SHEET CONTENT: STREET IMPROVEMENTS CROSS ROAD STA 12+79.32 TO STA 16+00

SCALE: 1" = 20'
DATE: APR. 10, 2019
DESIGNER: J. B. BROWN
CHECKER: J. B. BROWN
DATE: APR. 10, 2019
PROJECT NO.: 18-001
SHEET NO.: 4 OF 10 SHEETS
DATE: APR. 10, 2019
PROJECT NO.: 18-001



BENCH MARK:
 BENCH MARK ELEVATION = 850.32 (NAD 83) 1007
 BENCH MARK DESCRIPTION: 1" DIA. IRON ROD WITH 1/2" DIA. CAP AND 1/2" DIA. FLANGE. THE TOP OF THE ROD IS 1.0 FOOT SOUTH OF THE CORNER OF THE EAST CONCRETE CORNER.

CITY OF IMPERIAL
 420 South Imperial Avenue
 Imperial, CA 92251
 Ph. (760) 355-3840 • Fax: (760) 355-4718



UNAPPROVED CHANGES & DELETES: The engineer preparing these plans and not be responsible for, or liable for, whatsoever changes in or errors of these plans. All changes to the plans must be in writing and shall be approved by the preparer of these plans.

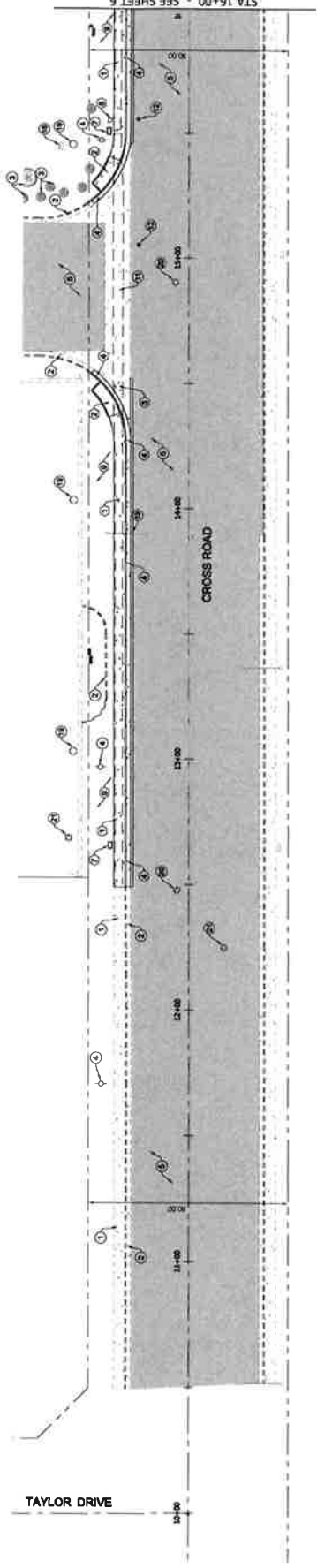

PLAN VIEW

NOTE: THE EXACT HORIZONTAL AND VERTICAL LOCATIONS OF THE EXISTING UNDERGROUND UTILITIES SHALL BE OBTAINED FROM THE UTILITY COMPANIES. THE CONTRACTOR SHALL VERIFY THE LOCATION AND DEPTH OF ALL UTILITIES PRIOR TO CONSTRUCTION. UTILITIES NOT IDENTIFIED AS SUCH SHALL BE CONSIDERED AS UNKNOWN UTILITIES. THE CONTRACTOR SHALL BE RESPONSIBLE FOR OBTAINING ALL NECESSARY PERMITS FROM THE LOCAL GOVERNMENT AND THE UTILITY COMPANIES. THE CONTRACTOR SHALL BE RESPONSIBLE FOR THE PROTECTION AND RELOCATION OF ALL UTILITIES TO REMAIN. THE CONTRACTOR SHALL BE RESPONSIBLE FOR THE PROTECTION AND RELOCATION OF ALL UTILITIES TO REMAIN. THE CONTRACTOR SHALL BE RESPONSIBLE FOR THE PROTECTION AND RELOCATION OF ALL UTILITIES TO REMAIN.

- EXISTING FACILITY KEYNOTES**
- 1 EXISTING SIDEWALK TO REMAIN
 - 2 EXISTING CURB AND GUTTER TO REMAIN
 - 3 EXISTING TREE/PALM TO REMAIN
 - 4 EXISTING POWER/TELEPHONE POLE TO REMAIN
 - 5 EXISTING A/C PAVEMENT TO REMAIN
 - 6 EXISTING SIGN TO REMAIN
 - 7 EXISTING DRIVEWAY TO REMAIN
 - 8 EXISTING FIRE HYDRANT TO REMAIN (PROTECT IN PLACE)
 - 9 EXISTING WATER METER TO REMAIN
 - 10 EXISTING GUY WIRE TO REMAIN
 - 11 EXISTING CROSS CUTTER TO REMAIN
 - 12 EXISTING WATER VALVE TO REMAIN
 - 13 EXISTING SEWER LINE TO REMAIN
 - 14 EXISTING WATER LINE TO REMAIN
 - 15 EXISTING AIR LINE TO REMAIN
 - 16 EXISTING UTILITY BOX TO REMAIN
 - 17 EXISTING EDGE OF PAVEMENT
 - 18 EXISTING P.C.C. HANDCAP CURB RAMP TO REMAIN
 - 19 EXISTING ELECTRICAL LIGHT POLE TO REMAIN
 - 20 EXISTING SWER MANHOLE TO REMAIN
 - 21 EXISTING STORM DRAIN MANHOLE TO REMAIN

- 1 INITIAL P.C.C. SIDEWALK PER DETAIL XX ON SHEET XX
- 2 INITIAL P.C.C. CURB RAMP PER DETAIL XX ON SHEET XX
- 3 INITIAL PORTION OF P.C.C. SIDEWALK PER DETAIL XX ON SHEET XX
- 4 INITIAL 4-INCH P.C.C. CURB AND GUTTER PER DETAIL XX ON SHEET XX
- 5 ADJUST THE EXISTING WATER VALVE TO REMAIN TO REMAIN
- 6 REMOVE AND RELOCATE EXISTING UTILITY BOX TO OTHER
- 7 EXISTING FIRE HYDRANT ASSEMBLY TO BE REPLACED BY THIS CONNECTION. THE LINE SHALL BE INSTALLED TO THE WATER MAIN AND SHALL BE COOPERATIVE WITH THE FIRE DEPARTMENT TO OBTAIN PERMITS FOR INSTALLATION OF THE FIRE HYDRANT.
- 8 AFTER THE PLACEMENT OF THE P.C.C. SIDEWALK ON THE P.C.C. CURB RAMP CUTTER IS COMPLETED AND THE WATER VALVE TO REMAIN IS ADJUSTED TO THE CORRECT POSITION, THE CONTRACTOR SHALL INSTALL A 2-INCH CONCRETE OVERLAY 12-INCH CONVENTIONAL MIX TYPE 1.5" TO 2" AROUND THE EXISTING CURB AND GUTTER TO REMAIN.



Dynamic CONSULTING ENGINEERS
 CALIFORNIA REGISTERED PROFESSIONAL ENGINEERS
 10400 JARVIS AVENUE, SUITE 200
 IMPERIAL, CA 92251
 TEL: (760) 939-0111

PROJECT TITLE: CITY OF IMPERIAL - ATEA BOULEVARD & CROSS ROAD INTERSECTION IMPROVEMENTS
SCALE: AS SHOWN
SHEET: 5
OF 10 SHEETS
DATE: APRIL 10, 2019
JOB NO.: DCE 391719

PREPARED UNDER THE DIRECT SUPERVISION OF:
 NAME: [Redacted]
SCALE: 1" = 20'
DATE: [Redacted]

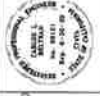

BENCH MARK:
 BENCHMARK LOCATION: 853.927 NAVD 88 + 10007
 BENCHMARK DESCRIPTION: BENCHMARK
 BENCH MARK IS A REINFORCING BOLT 1/2" DIA. WITH A NUT AND WASHER AT THE TOP OF A 1.0 FOOT SOUTH OF THE CENTER OF THE 60" CONCRETE PAD.

CITY OF IMPERIAL
 420 South Imperial Avenue
 Imperial, CA 92251
 Ph: (760) 365-3840 • Fax: (760) 365-4718



NO.	REVISIONS	APPROVED	DATE

UNAPPROVED CHANGES & USES: The engineer preparing these plans will not be responsible for any changes to the plans made after the date of their issue.

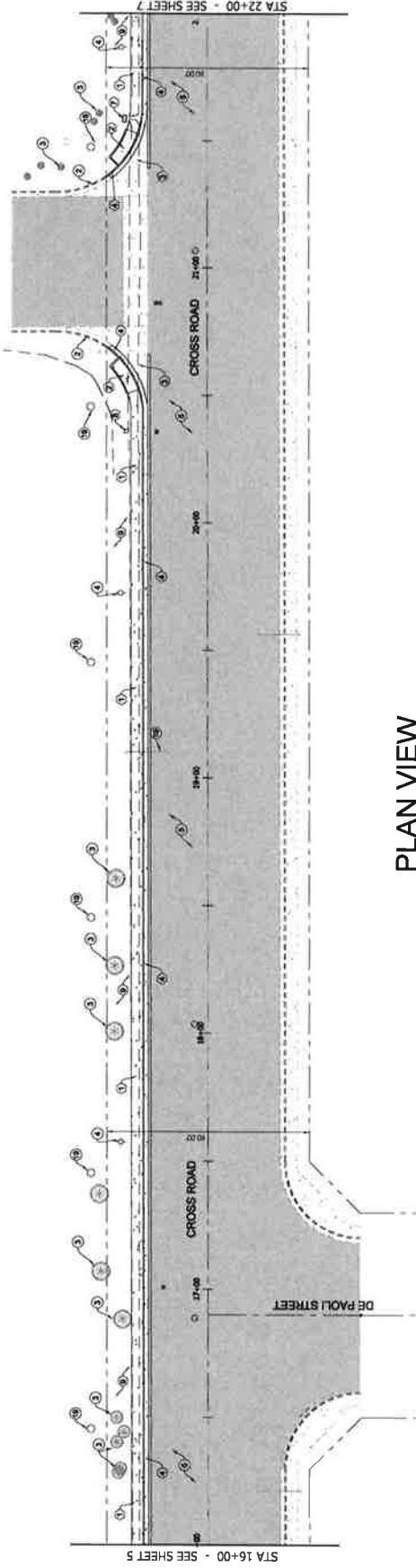

PLAN VIEW

EXISTING FACILITY KEYNOTES

- ① EXISTING SIDEWALK TO REMAIN
- ② EXISTING CURB AND GUTTER TO REMAIN
- ③ EXISTING TREE PALM TO REMAIN
- ④ EXISTING POWER/TELEPHONE POLE TO REMAIN
- ⑤ EXISTING A.C. PAVEMENT TO REMAIN
- ⑥ EXISTING BIOWASH TO REMAIN
- ⑦ EXISTING FIRE HYDRANT TO REMAIN (PROTECT IN PLACE)
- ⑧ EXISTING WATER METER TO REMAIN
- ⑨ EXISTING GUY WIRE TO REMAIN
- ⑩ EXISTING CROSS CUTTER TO REMAIN
- ⑪ EXISTING WATER VALVE TO REMAIN
- ⑫ EXISTING SEWER LINE TO REMAIN
- ⑬ EXISTING WATER LINE TO REMAIN
- ⑭ EXISTING AT&T LINE TO REMAIN
- ⑮ EXISTING UTILITY BOX TO REMAIN
- ⑯ EXISTING EDGE OF PAVEMENT
- ⑰ EXISTING P.C.C. HANDCAP CURB RAMP TO REMAIN
- ⑱ EXISTING ELECTRICAL LIGHT POLE TO REMAIN
- ⑲ EXISTING SEWER MANHOLE TO REMAIN
- ⑳ EXISTING STORM DRAIN MANHOLE TO REMAIN

1. CONCRETE CURB AND GUTTER TO REMAIN
2. METAL P.C.C. CURB RAMP PER CALTRANS STANDARD DRAWING DETAIL 'B' CASE C
3. METAL L-ARCH P.C.C. CURB AND GUTTER PER DETAIL 'C' ON SHEET 2X
4. METAL L-ARCH P.C.C. CURB AND GUTTER PER DETAIL 'C' ON SHEET 2X
5. ADJUST THE EXISTING WATER VALVE NUBS TO FORM INSTANT GRAB, AFTER FINISHING THE SURFACE OF THE CEMENT CURB RAMP PER DETAIL 'D' ON SHEET 2X
6. REMOVE AND RELOCATED EXISTING UTILITY BOX BY OTHERS
7. REMOVE AND RELOCATED EXISTING UTILITY BOX BY OTHERS
8. ADJUST FIRE HYDRANT ASSEMBLY TO BE RELICATED BY THE CONTRACTOR. THE FIRE HYDRANT SHALL BE RELICATED TO THE EXISTING LOCATION OF THE HYDRANT
9. WITH THE FIRE HYDRANT ASSEMBLY, THE CONTRACTOR SHALL PROVIDE COORDINATION WITH THE FIRE DEPARTMENT
10. ADJUST THE EXISTING WATER VALVE NUBS TO FORM INSTANT GRAB, AFTER FINISHING THE SURFACE OF THE CEMENT CURB RAMP PER DETAIL 'D' ON SHEET 2X
11. ADJUST THE EXISTING WATER VALVE NUBS TO FORM INSTANT GRAB, AFTER FINISHING THE SURFACE OF THE CEMENT CURB RAMP PER DETAIL 'D' ON SHEET 2X
12. ADJUST THE EXISTING WATER VALVE NUBS TO FORM INSTANT GRAB, AFTER FINISHING THE SURFACE OF THE CEMENT CURB RAMP PER DETAIL 'D' ON SHEET 2X
13. ADJUST THE EXISTING WATER VALVE NUBS TO FORM INSTANT GRAB, AFTER FINISHING THE SURFACE OF THE CEMENT CURB RAMP PER DETAIL 'D' ON SHEET 2X
14. ADJUST THE EXISTING WATER VALVE NUBS TO FORM INSTANT GRAB, AFTER FINISHING THE SURFACE OF THE CEMENT CURB RAMP PER DETAIL 'D' ON SHEET 2X
15. ADJUST THE EXISTING WATER VALVE NUBS TO FORM INSTANT GRAB, AFTER FINISHING THE SURFACE OF THE CEMENT CURB RAMP PER DETAIL 'D' ON SHEET 2X
16. ADJUST THE EXISTING WATER VALVE NUBS TO FORM INSTANT GRAB, AFTER FINISHING THE SURFACE OF THE CEMENT CURB RAMP PER DETAIL 'D' ON SHEET 2X
17. ADJUST THE EXISTING WATER VALVE NUBS TO FORM INSTANT GRAB, AFTER FINISHING THE SURFACE OF THE CEMENT CURB RAMP PER DETAIL 'D' ON SHEET 2X
18. ADJUST THE EXISTING WATER VALVE NUBS TO FORM INSTANT GRAB, AFTER FINISHING THE SURFACE OF THE CEMENT CURB RAMP PER DETAIL 'D' ON SHEET 2X
19. ADJUST THE EXISTING WATER VALVE NUBS TO FORM INSTANT GRAB, AFTER FINISHING THE SURFACE OF THE CEMENT CURB RAMP PER DETAIL 'D' ON SHEET 2X
20. ADJUST THE EXISTING WATER VALVE NUBS TO FORM INSTANT GRAB, AFTER FINISHING THE SURFACE OF THE CEMENT CURB RAMP PER DETAIL 'D' ON SHEET 2X
21. ADJUST THE EXISTING WATER VALVE NUBS TO FORM INSTANT GRAB, AFTER FINISHING THE SURFACE OF THE CEMENT CURB RAMP PER DETAIL 'D' ON SHEET 2X
22. ADJUST THE EXISTING WATER VALVE NUBS TO FORM INSTANT GRAB, AFTER FINISHING THE SURFACE OF THE CEMENT CURB RAMP PER DETAIL 'D' ON SHEET 2X
23. ADJUST THE EXISTING WATER VALVE NUBS TO FORM INSTANT GRAB, AFTER FINISHING THE SURFACE OF THE CEMENT CURB RAMP PER DETAIL 'D' ON SHEET 2X
24. ADJUST THE EXISTING WATER VALVE NUBS TO FORM INSTANT GRAB, AFTER FINISHING THE SURFACE OF THE CEMENT CURB RAMP PER DETAIL 'D' ON SHEET 2X
25. ADJUST THE EXISTING WATER VALVE NUBS TO FORM INSTANT GRAB, AFTER FINISHING THE SURFACE OF THE CEMENT CURB RAMP PER DETAIL 'D' ON SHEET 2X
26. ADJUST THE EXISTING WATER VALVE NUBS TO FORM INSTANT GRAB, AFTER FINISHING THE SURFACE OF THE CEMENT CURB RAMP PER DETAIL 'D' ON SHEET 2X
27. ADJUST THE EXISTING WATER VALVE NUBS TO FORM INSTANT GRAB, AFTER FINISHING THE SURFACE OF THE CEMENT CURB RAMP PER DETAIL 'D' ON SHEET 2X
28. ADJUST THE EXISTING WATER VALVE NUBS TO FORM INSTANT GRAB, AFTER FINISHING THE SURFACE OF THE CEMENT CURB RAMP PER DETAIL 'D' ON SHEET 2X
29. ADJUST THE EXISTING WATER VALVE NUBS TO FORM INSTANT GRAB, AFTER FINISHING THE SURFACE OF THE CEMENT CURB RAMP PER DETAIL 'D' ON SHEET 2X
30. ADJUST THE EXISTING WATER VALVE NUBS TO FORM INSTANT GRAB, AFTER FINISHING THE SURFACE OF THE CEMENT CURB RAMP PER DETAIL 'D' ON SHEET 2X
31. ADJUST THE EXISTING WATER VALVE NUBS TO FORM INSTANT GRAB, AFTER FINISHING THE SURFACE OF THE CEMENT CURB RAMP PER DETAIL 'D' ON SHEET 2X
32. ADJUST THE EXISTING WATER VALVE NUBS TO FORM INSTANT GRAB, AFTER FINISHING THE SURFACE OF THE CEMENT CURB RAMP PER DETAIL 'D' ON SHEET 2X
33. ADJUST THE EXISTING WATER VALVE NUBS TO FORM INSTANT GRAB, AFTER FINISHING THE SURFACE OF THE CEMENT CURB RAMP PER DETAIL 'D' ON SHEET 2X
34. ADJUST THE EXISTING WATER VALVE NUBS TO FORM INSTANT GRAB, AFTER FINISHING THE SURFACE OF THE CEMENT CURB RAMP PER DETAIL 'D' ON SHEET 2X
35. ADJUST THE EXISTING WATER VALVE NUBS TO FORM INSTANT GRAB, AFTER FINISHING THE SURFACE OF THE CEMENT CURB RAMP PER DETAIL 'D' ON SHEET 2X
36. ADJUST THE EXISTING WATER VALVE NUBS TO FORM INSTANT GRAB, AFTER FINISHING THE SURFACE OF THE CEMENT CURB RAMP PER DETAIL 'D' ON SHEET 2X
37. ADJUST THE EXISTING WATER VALVE NUBS TO FORM INSTANT GRAB, AFTER FINISHING THE SURFACE OF THE CEMENT CURB RAMP PER DETAIL 'D' ON SHEET 2X
38. ADJUST THE EXISTING WATER VALVE NUBS TO FORM INSTANT GRAB, AFTER FINISHING THE SURFACE OF THE CEMENT CURB RAMP PER DETAIL 'D' ON SHEET 2X
39. ADJUST THE EXISTING WATER VALVE NUBS TO FORM INSTANT GRAB, AFTER FINISHING THE SURFACE OF THE CEMENT CURB RAMP PER DETAIL 'D' ON SHEET 2X
40. ADJUST THE EXISTING WATER VALVE NUBS TO FORM INSTANT GRAB, AFTER FINISHING THE SURFACE OF THE CEMENT CURB RAMP PER DETAIL 'D' ON SHEET 2X
41. ADJUST THE EXISTING WATER VALVE NUBS TO FORM INSTANT GRAB, AFTER FINISHING THE SURFACE OF THE CEMENT CURB RAMP PER DETAIL 'D' ON SHEET 2X
42. ADJUST THE EXISTING WATER VALVE NUBS TO FORM INSTANT GRAB, AFTER FINISHING THE SURFACE OF THE CEMENT CURB RAMP PER DETAIL 'D' ON SHEET 2X
43. ADJUST THE EXISTING WATER VALVE NUBS TO FORM INSTANT GRAB, AFTER FINISHING THE SURFACE OF THE CEMENT CURB RAMP PER DETAIL 'D' ON SHEET 2X
44. ADJUST THE EXISTING WATER VALVE NUBS TO FORM INSTANT GRAB, AFTER FINISHING THE SURFACE OF THE CEMENT CURB RAMP PER DETAIL 'D' ON SHEET 2X
45. ADJUST THE EXISTING WATER VALVE NUBS TO FORM INSTANT GRAB, AFTER FINISHING THE SURFACE OF THE CEMENT CURB RAMP PER DETAIL 'D' ON SHEET 2X
46. ADJUST THE EXISTING WATER VALVE NUBS TO FORM INSTANT GRAB, AFTER FINISHING THE SURFACE OF THE CEMENT CURB RAMP PER DETAIL 'D' ON SHEET 2X
47. ADJUST THE EXISTING WATER VALVE NUBS TO FORM INSTANT GRAB, AFTER FINISHING THE SURFACE OF THE CEMENT CURB RAMP PER DETAIL 'D' ON SHEET 2X
48. ADJUST THE EXISTING WATER VALVE NUBS TO FORM INSTANT GRAB, AFTER FINISHING THE SURFACE OF THE CEMENT CURB RAMP PER DETAIL 'D' ON SHEET 2X
49. ADJUST THE EXISTING WATER VALVE NUBS TO FORM INSTANT GRAB, AFTER FINISHING THE SURFACE OF THE CEMENT CURB RAMP PER DETAIL 'D' ON SHEET 2X
50. ADJUST THE EXISTING WATER VALVE NUBS TO FORM INSTANT GRAB, AFTER FINISHING THE SURFACE OF THE CEMENT CURB RAMP PER DETAIL 'D' ON SHEET 2X

NOTE: EXACT HORIZONTAL AND VERTICAL LOCATIONS OF THE EXISTING UNDERGROUND UTILITIES ILLUSTRATED ON THE PLANS ARE UNKNOWN. THE EXISTING LOCATION OF GAS LATERALS, SANITARY SEWER, AND ELECTRICAL ALONG CROSS ROAD IS ILLUSTRATED ON THE PLANS. AN EFFORT WAS MADE TO OBTAIN AS-BUILT PLANS IN ORDER TO ACCURATELY ILLUSTRATE THE EXISTING KNOWN UTILITIES DURING DESIGN PHASE, HOWEVER, THE CONTRACTOR SHALL "POD-HOLE" THE EXISTING UNDERGROUND UTILITIES WITHIN THE LIMITS OF CONSTRUCTION UNDER A.C. PAVEMENT AND CONCRETE AREAS WITHIN FIVE (5) FEET FROM THE EXISTING UTILITY LOCATIONS TO VERIFY THE EXISTING UTILITY LOCATIONS AND VERIFY THAT THE EXISTING UTILITIES ARE LOCATED BELOW THE SUBBASE DESIGN ELEVATION. THE CONTRACTOR SHALL BE RESPONSIBLE FOR OBTAINING AND VERIFYING THE EXISTING UTILITIES WITH THE UTILITY COMPANY AND CONSTRUCTION MANAGER. IT SHALL BE VERIFIED THAT THE EXISTING UTILITIES ARE LOCATED BELOW THE SUBBASE DESIGN ELEVATION AND THE EXISTING UTILITIES ARE NOT UNDER ANY STRESS. THE CONTRACTOR SHALL OBSERVE THE UTILITIES PRIOR TO DEMOLITION OF THE ROADWAY. PIPELINES OBSERVED AND IDENTIFIED SHOULD BE PROTECTED BY INSTALLING CONSTRUCTION PROTECTIVE DEVICES AND PROTECTIVE COMPACT ON EQUIPMENT IN THE VICINITY OF THE UTILITIES.



NO WORK SHALL BE DONE ON THE UNDERGROUND UTILITIES UNLESS THE CONTRACTOR HAS OBTAINED WRITTEN PERMISSION TO OPEN OR REMOVE COVER FROM THE CITY OF IMPERIAL PUBLIC UTILITIES DEPARTMENT. CALL TOLL FREE 1-800-727-2600

DYNAMIC CONSULTING ENGINEERS
 CALIFORNIA REGISTERED PROFESSIONAL ENGINEERS
 1401 SOUTH MAIN STREET, SUITE 100
 IMPERIAL, CA 92251
 TEL: (760) 355-3840 FAX: (760) 355-4718

PROJECT TITLE: CITY OF IMPERIAL - ATEN BOULEVARD & CROSS ROAD INTERSECTION IMPROVEMENTS

SHEET NUMBER: 6 OF 10 SHEET

DATE: APR. 10, 2019

CROSS ROAD IMPROVEMENTS
 STA. 12+79.30 TO STA. 16+00

PREPARED UNDER THE DIRECT SUPERVISION OF
 PROJECT MANAGER: [Name]
 DATE: [Date]

CITY OF IMPERIAL
 420 South Imperial Avenue
 Imperial, CA 92251
 Ph: (760) 355-3840 • Fax: (760) 355-4718

NO.	REVISIONS	APPROVED	DATE

UNAUTHORIZED CHANGES & USES. The engineer preparing these plans will be responsible for any such changes. Any modifications are made in accordance with the provisions of the contract documents and shall be prepared by the engineer of their party.

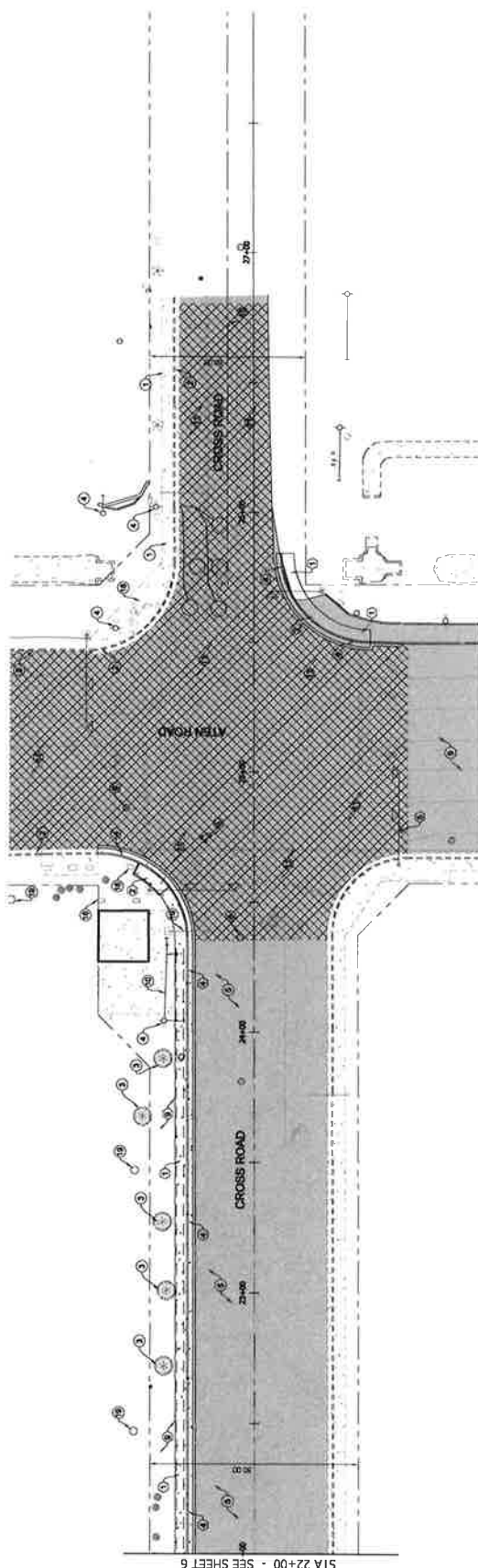

STA 22+00 - SEE SHEET 6

NOTE:
 THE EXACT HORIZONTAL AND VERTICAL LOCATIONS OF THE EXISTING UNDERGROUND UTILITIES AS SHOWN ON THESE PLANS ARE BASED ON THE EXISTING LOCATION OF GAS, WATER, SANITARY SEWER, LATERALS AND WASTEWATER SYSTEMS. AN EFFORT WAS MADE TO OBTAIN AS-BUILT PLANS IN ORDER TO ILLUSTRATE ON THE PLANS. HOWEVER, THE EXISTING UTILITIES DURING DESIGN PHASE, HOWEVER, THERE MAY BE CHANGES TO THE EXISTING UTILITIES. THE CONTRACTOR SHALL VERIFY THE EXISTING UTILITIES WITHIN THE LIMITS OF THE PROJECT WITHIN A C-PAVEMENT AND CONCRETE AREAS WITHIN FIVE (5) DAYS FROM THE COMMENCEMENT OF THE PROJECT WITH THE UTILITY COMPANIES AND CONSTRUCTION MANAGER. IT SHALL BE THE RESPONSIBILITY OF THE CONTRACTOR TO VERIFY THE EXISTING UTILITIES WITHIN THE LIMITS OF THE PROJECT WITHIN THE UTILITY COMPANIES AND CONSTRUCTION MANAGER. IT SHALL BE VERIFIED THAT THE EXISTING UTILITIES ARE LOCATED BELOW THE SUBGRADE DESIGN ELEVATION OF THE CROSSROADS. ALL EXISTING UTILITIES SHALL BE PROTECTED BY USING LIGHTER WEIGHT CONCRETE CURB AND GUTTERS. THE CONTRACTOR SHALL PROTECT ALL UTILITIES PRIOR TO REMOVAL OF THE ROADWAY. PHONES OBSERVED AND IDENTIFIED ON THESE PLANS SHALL BE PROTECTED BY USING LIGHTER WEIGHT CONCRETE CURB AND GUTTERS.

- EXISTING FACILITY KEYNOTES**
- 1 EXISTING SIDEWALK TO REMAIN
 - 2 EXISTING CURB AND GUTTER TO REMAIN
 - 3 EXISTING TREE PALM TO REMAIN
 - 4 EXISTING POWER/TELEPHONE POLE TO REMAIN
 - 5 EXISTING A/C PAVEMENT TO REMAIN
 - 6 EXISTING SIGN TO REMAIN
 - 7 EXISTING DRAINWAY TO REMAIN
 - 8 EXISTING FIRE HYDRANT TO REMAIN (PROJECT IN PLACE)
 - 9 EXISTING WATER METER TO REMAIN
 - 10 EXISTING GUY WIRE TO REMAIN
 - 11 EXISTING CROSS GUTTER TO REMAIN
 - 12 EXISTING WATER VALVE TO REMAIN
 - 13 EXISTING SEWER LINE TO REMAIN
 - 14 EXISTING WATER LINE TO REMAIN
 - 15 EXISTING AT-AT LINE TO REMAIN
 - 16 EXISTING UTILITY BOX TO REMAIN
 - 17 EXISTING EDGE OF PAVEMENT
 - 18 EXISTING P.C.C. HANDICAP CURB RAMP TO REMAIN
 - 19 EXISTING ELECTRICAL LIGHT POLE TO REMAIN
 - 20 EXISTING SEWER MANHOLE TO REMAIN
 - 21 EXISTING STORM DRAIN MANHOLE TO REMAIN

- CONSTRUCTION KEYNOTES**
- 1 INITIAL P.C.C. SIDEWALK PER DETAIL XX ON SHEET XX
 - 2 INITIAL P.C.C. CURB RAMP PER DETAIL XX ON SHEET XX
 - 3 INITIAL PORTION OF P.C.C. SPANDREL PER DETAIL XX ON SHEET XX
 - 4 INITIAL LATCH P.C.C. CURB AND GUTTER PER DETAIL XX ON SHEET XX
 - 5 ADJUST THE EXISTING WATER VALVE HEADS TO MATCH EXISTING MANHOLE AFTER PAVING
 - 6 ADJUST THE EXISTING WATER VALVE HEADS TO MATCH EXISTING MANHOLE AFTER PAVING
 - 7 ADJUST THE EXISTING WATER VALVE HEADS TO MATCH EXISTING MANHOLE AFTER PAVING
 - 8 ADJUST THE EXISTING WATER VALVE HEADS TO MATCH EXISTING MANHOLE AFTER PAVING
 - 9 ADJUST THE EXISTING WATER VALVE HEADS TO MATCH EXISTING MANHOLE AFTER PAVING
 - 10 ADJUST THE EXISTING WATER VALVE HEADS TO MATCH EXISTING MANHOLE AFTER PAVING
 - 11 ADJUST THE EXISTING WATER VALVE HEADS TO MATCH EXISTING MANHOLE AFTER PAVING
 - 12 ADJUST THE EXISTING WATER VALVE HEADS TO MATCH EXISTING MANHOLE AFTER PAVING
 - 13 ADJUST THE EXISTING WATER VALVE HEADS TO MATCH EXISTING MANHOLE AFTER PAVING
 - 14 ADJUST THE EXISTING WATER VALVE HEADS TO MATCH EXISTING MANHOLE AFTER PAVING
 - 15 ADJUST THE EXISTING WATER VALVE HEADS TO MATCH EXISTING MANHOLE AFTER PAVING
 - 16 ADJUST THE EXISTING WATER VALVE HEADS TO MATCH EXISTING MANHOLE AFTER PAVING
 - 17 ADJUST THE EXISTING WATER VALVE HEADS TO MATCH EXISTING MANHOLE AFTER PAVING
 - 18 ADJUST THE EXISTING WATER VALVE HEADS TO MATCH EXISTING MANHOLE AFTER PAVING
 - 19 ADJUST THE EXISTING WATER VALVE HEADS TO MATCH EXISTING MANHOLE AFTER PAVING
 - 20 ADJUST THE EXISTING WATER VALVE HEADS TO MATCH EXISTING MANHOLE AFTER PAVING
 - 21 ADJUST THE EXISTING WATER VALVE HEADS TO MATCH EXISTING MANHOLE AFTER PAVING

NO WORK SHALL BE DONE IN THE
 UNDERGROUND SERVICE AREAS
 UNLESS THE CONTRACTOR HAS
 OBTAINED THE NECESSARY
 PERMISSIONS FROM THE
 UTILITY COMPANIES AND
 CONSTRUCTION MANAGER.

Call TOLL FREE
 1-800-727-2600

Underground Service Alert
 CAUTION: MAY BE UNDERGROUND
 UTILITIES ARE LOCATED IN THIS
 AREA.

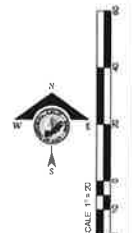

DYNAMIC CONSULTING ENGINEERS
 CALIFORNIA REGISTERED PROFESSIONAL ENGINEERS
 CIVIL ENGINEERING DIVISION - LICENSE NO. 43675
 15001 PULVERIDGE DRIVE, SUITE 200
 SAN DIEGO, CA 92128

PROJECT TITLE: CITY OF IMPERIAL - ATEN BOULEVARD & CROSS ROAD INTERSECTION IMPROVEMENTS

SCALE: DRAWN BY: DS, TM

REVISIONS: CE

SHEET: 7

OF 10 SHEETS

DATE: APRIL 10, 2018

PROJECT TITLE: CITY OF IMPERIAL - ATEN BOULEVARD & CROSS ROAD INTERSECTION IMPROVEMENTS

SHEET CONTENT: STREET IMPROVEMENTS CROSS ROAD STA 12+79.32 TO STA 16+00

PREPARED UNDER THE DIRECT SUPERVISION OF: [NAME]

DESIGNED BY: [NAME]

DRAWN BY: DS, TM

DATE: [DATE]



BENCH MARK:
 BENCHMARK LOCATION: 459.32 (NAVD 88 + 1000)
 BENCHMARK DESCRIPTION: TANGULAR BENCHMARK DISK SET IN A RETAINING WALL 0.15 MILE SOUTHWEST OF THE INTERSECTION OF ATEN ROAD AT THE TOP OF THE BENCH MARK. THE BENCH MARK IS APPROXIMATELY 1.0 FOOT SOUTH OF THE NORTH END OF THE EAST CONCRETE HORIZONTAL

CITY OF IMPERIAL
 420 South Imperial Avenue
 Imperial, CA 92251
 Ph: (760) 355-3840 • Fax: (760) 355-4718

NO.	REVISIONS	APPROVED	DATE

UNAUTHORIZED CHANGES & USES: The engineer preparing these plans, and not his representative, is responsible for the design. No changes shall be made in these plans without the express written consent of the engineer. All changes to the plans must be made on a separate sheet and shall be approved by the engineer of these plans.

CONSTRUCTION NOTES:

- 1. INSTALL DOUBLE YELLOW LINE PER CALTRANS STANDARD PLAN A24A DETAIL 27
- 2. INSTALL DOUBLE YELLOW LINE PER CALTRANS STANDARD PLAN A24A DETAIL 23
- 3. INSTALL 8" WHITE CHANNELIZING LINE PER CALTRANS STANDARD PLAN A24A DETAIL 38A
- 4. INSTALL 8" WHITE CHANNELIZING LINE PER CALTRANS STANDARD PLAN A24A DETAIL 38C
- 5. INSTALL WHITE LANELINE PER CALTRANS STANDARD PLAN A24A DETAIL 10 DETAIL 27S
- 6. INSTALL "STOP" PAVEMENT LEGEND PER CALTRANS STANDARD PLAN A240
- 7. INSTALL 12 INCH WHITE LIMIT LINE PER CALTRANS STANDARD PLAN A24E
- 8. INSTALL CONVENTIONAL CROSSWALK MARKINGS MARKINGS SHALL BE PER CAMUTO RETROREFLECTIVITY COMPLIANT AND SMO RESISTANT.

LEGEND:

- INSTALL TYPE 1 (T) ARROWS PER CALTRANS STANDARD PLAN A24A
- INSTALL TYPE IV (I) ARROW PER CALTRANS STANDARD PLAN A24A
- INSTALL TYPE IV (R) ARROW PER CALTRANS STANDARD PLAN A24A
- INSTALL TYPE W (R) ARROW PER CALTRANS STANDARD PLAN A24A

STRIPING TO BE THERMOPLASTIC

EXISTING AC PAVEMENT

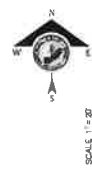
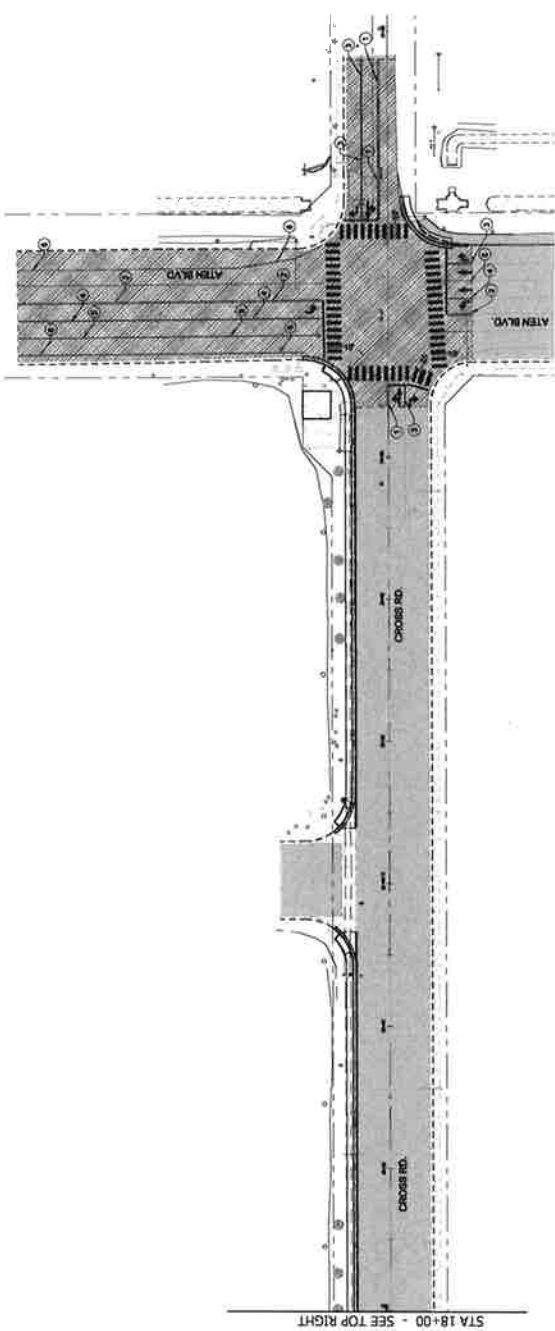
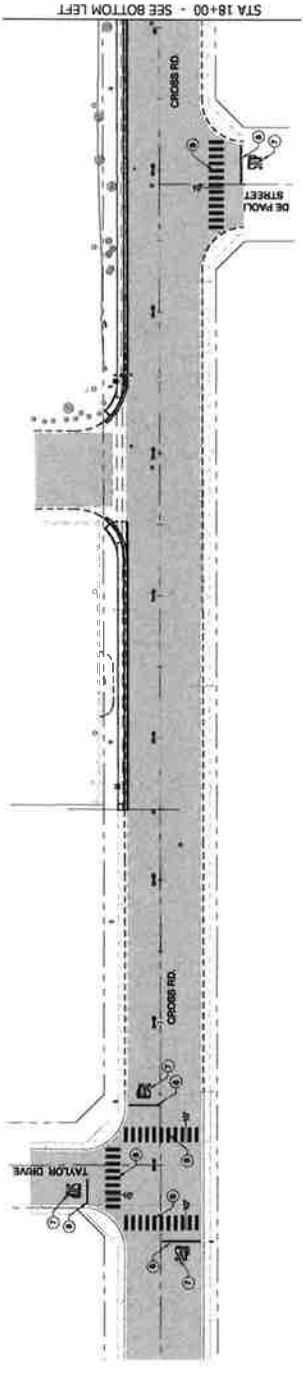

Dynamic CONSULTING ENGINEERS
 CALIFORNIA LICENSED PROFESSIONAL ENGINEER
 IMPERIAL, CA 92251
 TEL: (760) 355-3840 FAX: (760) 355-4718

NO WORK SHALL BE DONE ON THIS PROJECT WITHOUT THE ASSISTANCE OF AN UNDERGROUND SERVICE ALERT (USA) CALL BOX. CALL 811 TO LOCATE CALL BOXES.
 31-800-368-8277-7600

SCALE	SHEET
DRAWN BY: DR IV	8
REVISED BY: CS	OF 10 SHEET
DATE: APRIL 10, 2018	JCE-593718

PROJECT TITLE: CITY OF IMPERIAL - ATEN BOULEVARD & CROSS ROAD INTERSECTION IMPROVEMENTS
 SHEET CONTENT: STRIPING PLAN

PREPARED UNDER THE DIRECT SUPERVISION OF
 CARLOS L. BELTRAN, P.E.
 DATE: _____



BENCH MARK:
 BENCHMARK LOCATION: 343.22' NWD 58+1.000'
 BENCHMARK DESCRIPTION: 1.5" DIA. ALUMINUM BENCH MARK
 20K SLOPE 1/4" DIA. STAINLESS STEEL 1/2" DIA. NAIL
 NORTH END OF THE BENCH MARK IS ATEN BLVD AT THE TOP OF 1.0 FOOT SOUTH OF THE NORTH END OF THE LAST CONCRETE CURBLINE.

CITY OF IMPERIAL
 420 South Imperial Avenue
 Imperial, CA 92251
 Ph: (760) 355-3840 • Fax: (760) 355-4718



NO.	REVISIONS	APPROVED	DATE

UNAUTHORIZED CHANGES & USE: The engineer preparing these plans will not be responsible for or make any unauthorized changes to or use of these plans. All changes to the plans shall be in writing and shall be approved by the engineer of these plans.